



SUPRA
TECHNOLOGIES



UTENSILI PER PRESSE PIEGATRICI



TOOLING FOR PRESS BRAKES



UTILLAJE PARA PLEGADORA



UTILLAJE PARA DOBRADEIRAS



OUTILS POUR PRESSE PLIEUSE



WERKZEUGE FÜR ABKANTPRESSEN



ED05



MAGENTA LINE

ADAPTERS FOR ALL PRESS BRAKES

www.supra-technologies.com



EXPERIENCE & INNOVATION



Da più di 30 anni mettiamo la nostra esperienza al servizio del cliente, progettando e producendo utensili per tutti i tipi di presse piegatrici e cesoie. I prodotti Tecnostamp vengono interamente progettati e costruiti in Italia e commercializzati in tutto il mondo; la nostra azienda offre anche un efficiente servizio post-vendita garantito dalla competenza dei nostri tecnici e dall'assistenza telefonica dell'ufficio commerciale.



For over 30 years Tecnostamp designs and produces tools for all types of press brakes and shears, offering its experience to meet customer requirements. Tecnostamp products are fully designed and produced in Italy and they are sold worldwide; our company also offers an efficient after sales service guaranteed by the experience of our technicians and by the helpline of our sales department.



De más de 30 años, empleamos nuestra experiencia al servicio del cliente, proyectando y produciendo utillajes para todo tipo de prensas plegadoras y cizalladura. Tecnostamp produce en su propia fabrica todos los productos y comercializa en todo el mundo; nuestra empresa también ofrece un servicio post-venta eficiente garantizado por la experiencia de nuestros técnicos y la asistencia telefónica de oficina comercial.



Há mais de 30 anos que colocámos a nossa experiência ao serviço do cliente, projetando e produzindo ferramentas para todos de tipos de quinadoras/dobradeiras e fesoura. Os produtos Tecnostamp são inteiramente projetados e construídos em Itália e comercializados em todo o mundo; a nossa empresa também oferece um serviço pós-venda eficiente garantido pela experiência dos nossos técnicos e pela assistência telefónica de nosso escritório de vendas.



Depuis plus de 30 ans, nous mettons notre expérience au service de la clientèle, avec la conception et la production d'outils pour presses plieuses et cisailles. Les produits Tecnostamp sont entièrement conçus et fabriqués en Italie et vendus dans le monde; notre entreprise offre un service après-vente garanti par la compétence de nos techniciens et l'assistance téléphonique de notre bureau commercial.



Seit mehr als 30 Jahren setzt Tecnostamp seine Erfahrung in der Kundenbetreuung, Entwicklung und der Herstellung von Abkantwerkzeuge für alle Typen von Abkantpressen ein und scher. Unsere Produkte werden komplett in Italien entworfen, hergestellt und weltweit verkauft. Unser Unternehmen bietet Ihnen auch einen effizienten After-Sales-Service durch das Know-How unserer Techniker und die Hotline unseres Vertriebsbüros.



OUR LINES

- RED LINE
- ORANGE LINE
- YELLOW LINE
- GREEN LINE
- BLUE LINE
- MAGENTA LINE
- CORAL LINE
- GOLD LINE
- SILVER LINE
- BLACK LINE
- RAINBOW LINE



TABELLA DI PIEGATURA

FORZA NECESSARIA PER PIEGA A 90° IN ARIA DI LAMIERA CON RESISTENZA
 FORCE REQUIRED FOR 90° AIR BENDING, SHEET RESISTANCE
 FUERZA NECESARIA PARA PLEGAR A 90° CON LA RESISTENCIA
 FORÇA NECESSÁRIA PARA QUINAR/DOBRAR NO AR A 90° COM RESISTÊNCIA
 FORCE NÉCESSAIRE POUR LE PLIAGE EN L'AIR À 90° AVEC RÉSISTANCE
 ERFORDERLICHE PRESSKRAFT FÜR 90° FREIBIEGEN, ZUGFESTIGKEIT



R=45 Kg/mmq

| T mm | 6 | 8 | 10 | 12 | 16 | 20 | 25 | 32 | 40 | 50 | 63 | 80 | 100 | 125 | 160 | 200 | 250 | V |
|---------|----|-----|-----|-----|-----|-----|------|----|-----|-----|-----|-----|-----|-----|-----|-----|-----|-----|
| | 4 | 5.5 | 7 | 8.5 | 11 | 14 | 17.5 | 22 | 28 | 35 | 45 | 55 | 71 | 89 | 113 | 140 | 175 | B |
| | 1 | 1.3 | 1.6 | 2 | 2.6 | 3.3 | 4 | 5 | 6.5 | 8 | 10 | 13 | 16 | 20 | 26 | 33 | 41 | Ri |
| 0.5 | 3 | | | | | | | | | | | | | | | | | |
| 0.6 | 4 | 4 | | | | | | | | | | | | | | | | |
| 0.8 | 7 | 5 | 4 | | | | | | | | | | | | | | | |
| 1 | 11 | 8 | 7 | 6 | | | | | | | | | | | | | | |
| 1.2 | 16 | 12 | 10 | 8 | 6 | | | | | | | | | | | | | |
| 1.5 | | 17 | 15 | 13 | 9 | 8 | | | | | | | | | | | | |
| 2 | | | 27 | 22 | 17 | 13 | 11 | | | | | | | | | | | |
| 2.5 | | | | 35 | 26 | 21 | 17 | 13 | | | | | | | | | | |
| 3 | | | | | 38 | 30 | 24 | 19 | 15 | | | | | | | | | |
| 4 | | | | | | 54 | 42 | 34 | 27 | 21 | | | | | | | | |
| 5 | | | | | | | 67 | 52 | 42 | 33 | 26 | | | | | | | |
| 6 | | | | | | | | 75 | 60 | 48 | 38 | 30 | | | | | | |
| 8 | | | | | | | | | 107 | 85 | 68 | 53 | 43 | | | | | |
| 10 | | | | | | | | | | 134 | 105 | 85 | 67 | 53 | | | | |
| 12 | | | | | | | | | | | 153 | 120 | 96 | 78 | 60 | | | |
| 15 | | | | | | | | | | | | 188 | 150 | 120 | 95 | 75 | | F |
| 20 | | | | | | | | | | | | | 270 | 215 | 170 | 135 | 108 | t/m |

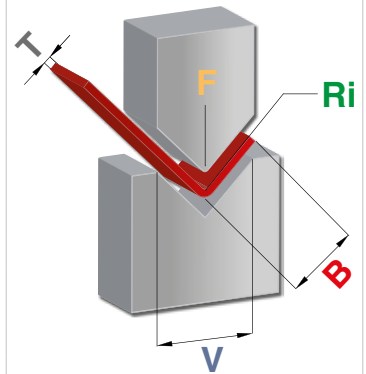

| | |
|---|-----------|
| SPESSORE LAMIERA IN MM - THICKNESS OF THE SHEET IN MM - ESPESOR DE CHAPA MM ESPESSURA DA CHAPA EM MM - ÉPAISSEUR DE TÔLE EN MM - MATERIALDICKE IN MM | T |
| FORZA IN TON /METRO - FORCE IN TON /METER - FUERZA TON/METRO FORÇA TON/METRO - FORCE EN TON/METRE - PRESSKRAFT IN T/M | F |
| RAGGIO INTERNO - INSIDE RADIUS - RADIO INTERIOR - RAO INTERNO - RAYON INTÉRIEUR - INNENRADIUS | Ri |
| BORDO MINIMO POSSIBILE - MINIMUM FLANGE LENGHT - ALA MINIMA ABA MINIMA - BORD MINI POSSIBLE - KÜRZESTE SCHENKELLANGE | B |
| LARGHEZZA DEL V - V-OPENING - APERTURA MATRIZ - ABERTURA DO V - LARGEUR DU VE - MATRIZENÖFFNUNGSWEITE V | V |

| | |
|--|---|
| CALCOLO DELLA FORZA PER PIEGA IN ARIA | $F = \frac{T^2 \times 2 \times R}{1.4 \times V} = \dots\dots\dots \text{Tons/mt}$ |
| CALCULATION OF FORCE FOR AIR BENDING | |
| CÁLCULO DE LA FUERZA DE PLEGADO AL AIRE | |
| CÁLCULO DE FORÇA DA QUINAGEM/DOBRA NO AR | |
| CALCUL DE LA FORCE POUR PLIAGE EN L'AIR | |
| BESTIMMUNG DER PRESSKRAFT | |

| | |
|---|-----------------------|
| ALLUMINIO - ALUMINIUM - ALUMINIO - ALUMINIO - ALUMINIUM - ALUMINIUM | R=20-25 KG/MMQ |
| ACCIAO DOLCE - MILD STEEL - ACERO - AÇO - ACIER - STAHL | R=40-45 KG/MMQ |
| INOX - STAINLESS STEEL - INOX - INOX - ACIER INOXYDABLE - EDELSTAHL | R=65-70 KG/MMQ |

| | | | | |
|---|------------------|--------------|---------------|-------------------|
| RAPPORTO TRA SPESSORE DI LAMIERA E AMPIEZZA DEL V - SHEET THICKNESS / V- WIDTH | | | | |
| CHAPA ESPESOR / ANCHO V - ESPESSURA DA CHAPA / LARGURA V | | | | |
| RAPPORT ÉPAISSEUR DE TÔLE / LARGEUR DU VE - MATERIALDICKE / MATRIZENÖFFNUNGSWEITE V | | | | |
| SPESSORE LAMIERA (mm) - SHEET THICKNESS (mm) - ESPESOR DE CHAPA (mm) ESPESSURA DA CHAPA (mm) - ÉPAISSEUR DE TÔLE (mm) - MATERIALDICKE (mm) | 0.5 - 2.5 | 3 - 8 | 9 - 10 | 12 OR MORE |
| AMPIEZZA DEL V (mm) - V - WIDTH (mm) - ANCHO V (mm) LARGURA V (mm) - LARGEUR DU VE (mm) - MATRIZENÖFFNUNGSWEITE V (mm) | 6 T | 8 T | 10 T | 12 T |

INDEX

| | |
|--|----|
| INTRODUZIONE | 2 |
| INTRODUCTION - INTRODUCCIÓN - INTRODUÇÃO - INTRODUCTION - EINFÜHRUNG | |
| TABELLA DI PIEGATURA | 3 |
| BENDING CHART - TABLA DE PLEGADO - TABELA DE QUINAGEM/DOBRA - ABAQUE DE PLIAGE - PRESSKRAFTTABELLE | |
| TRATTAMENTI TERMICI E TIPO DI MATERIALE | 5 |
| HARDENED TREATMENT AND TYPE OF MATERIAL - TRATAMIENTOS ENDURECIDOS Y TIPO DE MATERIAL TRATAMENTOS TÉRMICOS E TIPO DE MATERIAL - TRAITEMENTS THERMIQUES ET TYPE DE MATÉRIEL - HÄRTEBEHANDLUNG UND ART DES MATERIALS | |
| ADATTATORI | 7 |
| ADAPTERS - ADAPTADORES - ADAPTADORES - ADAPTATEURS - ADAPTER | |
| ADATTATORI SWING | 17 |
| SWING ADAPTERS - SWING ADAPTADORES - SWING ADAPTADORES - SWING ADAPTATEURS - SWING ADAPTER | |
| STAFFE PER INTERMEDIARI | 21 |
| CLAMP PLATES FOR ADAPTERS - BRIDAS PARA INTERMEDIARIOS AJUSTABLES Y FIJOS - BARRAS PARA INTERMEDIÁRIOS AJUSTÁVEIS E FIXOS BRIDES POUR INTERMÉDIAIRES FIXES ET REGLABLES - KLEMMBRIDEN FÜR ZWISCHENSTÜCKE UND VERSTELLBARE ZWISCHENSTÜCK | |
| ADATTATORI INFERIORI | 27 |
| LOWER ADAPTERS - ADAPTADORES INFERIOR - ADAPTADOR INFERIOR - ADAPTATEURS INFÉRIEURS - MATRIZENADAPTER | |
| CANALINE MODULARI | 31 |
| MODULAR HOLDERS - CANAL MODULAR - PORTA-MATRIZ MODULAR - SEMELLE PORTE-MATRICES MODULABLE - MATRIZENADAPTERSCHIENEN MODULAR | |
| RAPID CLARK | 35 |
| INTERMEDIARI PNEUMATICI -PNEUMATIC INTERMEDIATE - AMARRE NEUMÁTICO - INTERMEDIÁRIO PNEUMÁTICO INTERMÉDIAIRES PNEUMATIQUE - PNEUMATISCHE WERKZEUGKLEMMUNG | |
| INDEX CODE | 44 |
| INDEX CODE - INDEX CODE - INDEX CODE - INDEX CODE - INDEX CODE - INDEX CODE | |

TRATTAMENTI TERMICI E TIPO DI MATERIALE

TRATTAMENTI TERMICI - HARDENED TREATMENT - TRATAMIENTOS ENDURECIDOS - TRATAMENTOS TÉRMICOS - TRAITEMENTS THERMIQUES - HÄRTEBEHANDLUNG

GLI UTENSILI STANDARD E SPECIALI SONO TEMPRATI AD INDUZIONE SULLE PARTI USURABILI A 52-55 HRC.

THE STANDARD AND SPECIAL TOOLS ARE INDUCTION HARDENED TO 52-55 HRC ON WEAR PARTS.

LAS HERRAMIENTAS ESTÁNDAR Y ESPECIALES VIENEN TEMPLADAS POR INDUCCIÓN DE 52-55 HRC EN PIEZAS DE DESGASTE.

AS FERRAMENTAS STANDARD E ESPECIAIS SÃO TEMPERADAS POR INDUÇÃO 52-55 HRC NA ZONA DE DESGASTE.

LES OUTILS STANDARDS ET SPÉCIAUX SONT TREMPÉS PAR INDUCTION À 52-55 HRC SUR LES PARTIES TRAVAILLANTES.

DIE VERSCHLEISSTEILE DER STANDARD UND SONDERWERKZEUGE SIND INDUKTIV AUF 52-55HRC GEHÄRTET.

TRATTAMENTI ANTIUSURA - ANTIWEAR TREATMENT - TRATAMIENTOS ANTI-DESGASTE - TRATAMENTOS ANTI-DESGASTE - TRAITEMENTS ANTI-USURE - BEHANDLUNG FÜR VERSCHLEISSSCHUTZ

A RICHIESTA DEL CLIENTE, SUGLI UTENSILI COSTRUITI IN 42CRM04, PUÒ ESSERE FATTO UN TRATTAMENTO ANTIUSURA DI NITRURAZIONE.

ON REQUEST ON THE TOOLING IN 42CRM04 TECNOSTAMP CAN MAKE AN ANTIWEAR-NITRIDING TREATMENT.

OPCIONALMENTE, AL UTILLAJE EN 42CRM04, SE LE PUEDE HACER UN TRATAMIENTO ANTI-DESGASTE – NITRURACIÓN.

A PEDIDO DO CLIENTE EM FERRAMENTAS FABRICADAS EM 42CRM04, TECNOSTAMP PODE FAZER UM TRATAMENTO DE NITRETAÇÃO ANTI-DESGASTE.

SUR DEMANDE LES OUTILS EN 42CRM04 PEUVENT SUBIR UN TRAITEMENT ANTI-USURE EN NITRURATION.

AUF ANFRAGE AUF DEM WERKZEUG IN 42CRM04 TECNOSTAMP KANN EINE ANTIWEAR-NITRIERBEHANDLUNG ZU MACHEN.

TRATTAMENTI ANTIRUGGINE - RUSTING TREATMENT - TRATAMIENTOS ANTI-OXIDACIÓN - TRATAMENTOS ANTI OXIDAÇÃO - TRAITEMENTS ANTIROUILLE - BEHANDLUNG GEGEN ROST

A RICHIESTA DEL CLIENTE SUGLI UTENSILI PUÒ ESSERE FATTO IL TRATTAMENTO ANTI RUGGINE DI ZINCATURA.

AN ANTI RUST-GALVANIZED TREATMENT CAN BE MADE ON TOOLS ON REQUEST.

OPCIONALMENTE, A LOS UTILLAJES SE LES PUEDE DAR UN TRATAMIENTO ANTI-ÓXIDO-GALVANIZADO.

A PEDIDO DO CLIENTE, A TECNOSTAMP PODE FAZER UM TRATAMENTO ANTIFERRUGEM ZINCADO.

SUR DEMANDE UN TRAITEMENT ANTI-ROUILLE PEUT ÊTRE RÉALISÉ EN GALVANISÉ.

AUF ANFRAGE KANN TECNOSTAMP MEINE ANTI-RUST BEHANDLUNG ANBIETEN.

TIPO DI MATERIALE - TYPE OF MATERIAL - TIPO DE MATERIAL UTILIZADO - TIPO DE MATERIAL UTILIZADO - TYPE DE MATÉRIEL - ART DES MATERIALS

ACCIAIO C45 (UNI EN 10083 W.1. : 1.1191).

STEEL C45 (UNI EN 10083 W.1. : 1.1191).

ACERO C45 (UNI EN 10083 W.1. : 1.1191).

AÇO C45 (UNI EN 10083 W.1. : 1.1191).

ACIER C45 (UNI EN 10083 W.1. : 1.1191).

STAHL C45 (UNI EN 10083 W.1. : 1.1191).

ACCIAIO C45 (UNI EN 10083 W.1. : 1.1191) TEMPRATO AD INDUZIONE (52/55 HRC) SULLE PARTI USURABILI.

STEEL C45 (UNI EN 10083 W.1. : 1.1191) INDUCTION TEMPERED (52-55 HRC) ON WEAR PARTS.

ACERO C45 (UNI EN 10083 W.1. : 1.1191) TEMPLADO A INDUCCIÓN EN ZONA DE DESGASTE (52/55 HRC).

AÇO C45 (UNI EN 10083 W.1. : 1.1191) TEMPERADO POR INDUÇÃO NAS ZONAS DE DESGASTE (52-55 HRC).

ACIER C45 (UNI EN 10083 W.1. : 1.1191) TREMPÉ PAR INDUCTION (52-55 HRC) SUR LES PARTIES TRAVAILLANTES.

STAHL C45 (UNI EN 10083 W.1. : 1.1191), VERSCHLEISSTEILE INDUKTIV AUF (52-55HRC) GEHÄRTET.

ACCIAIO C45 (UNI EN 10083 W.1. : 1.1191) BONIFICATO R=80-85 KG/MMQ TEMPRATO AD INDUZIONE (52/55 HRC) SULLE PARTI USURABILI.

STEEL C45 (UNI EN 10083 W.1. : 1.1191) HARDENED R=80-85 KG/MMQ INDUCTION TEMPERED (52-55 HRC) ON WEAR PARTS.

ACERO C45 (UNI EN 10083 W.1. : 1.1191) BONIFICADO R=80-85 KG/MMQ TEMPLADO A INDUCCIÓN EN ZONA DE DESGASTE (52/55 HRC).

AÇO C45 (UNI EN 10083 W.1. : 1.1191) BONIFICADO R=80-85 KG/MMQ TEMPERADO POR INDUÇÃO NAS ZONAS DE DESGASTE (52-55 HRC).

ACIER C45 (UNI EN 10083 W.1. : 1.1191) RESISTANCE R = 80-85 KG/MMQ ET TREMPÉ PAR INDUCTION (52-55 HRC) SUR LES PARTIES TRAVAILLANTES.

STAHL C45 (UNI EN 10083 W.1. : 1.1191) VERGÜTET R=80-85 KG/MM2 AN DEN ABNUTZUNGSKANTEN INDUKTIV GEHÄRTET AUF (52/55 HRC).

ACCIAIO 42CRM04 (UNI EN 10083 W.1. : 1.7225) BONIFICATO R=95-105 KG/MMQ TEMPRATO AD INDUZIONE (52/55 HRC) SULLE PARTI USURABILI.

STEEL 42 CRM04 (UNI EN 10083 W.1. : 1.7225) HARDENED R=95-105 KG/MMQ INDUCTION TEMPERED (52-55 HRC) ON WEAR PART.

ACERO 42CRM04 (UNI EN 10083 W.1. : 1.7225) BONIFICADO R=95-105 KG/MMQ TEMPLADO A INDUCCIÓN EN ZONA DE DESGASTE (52/55 HRC).

AÇO 42 CRM04 (UNI EN 10083 W.1. : 1.7225) BONIFICADO R=95-105 KG/MMQ TEMPERADO POR INDUÇÃO NAS ZONAS DE DESGASTE (52-55 HRC).

ACIER 42 CRM04 (UNI EN 10083 W.1. : 1.7225) RESISTANCE R=95-105 KG/MMQ ET TREMPÉ PAR INDUCTION (52-55 HRC) SUR LES PARTIES TRAVAILLANTES.

STAHL 42 CRM04 (UNI EN 10083 W.1. : 1.7225) VERGÜTET R=95-105 KG/MM2 AN DEN ABNUTZUNGSKANTEN INDUKTIV GEHÄRTET AUF (52/55 HRC).



ADATTATORI INTERMEDIARI



MAGENTA LINE

ADAPTERS FOR ALL PRESS BRAKES

ADATTATORI/INTERMEDIARI/CANALINE - ADAPTERS/INTERMEDIATES/HOLDERS

ADAPTADORES/INTERMEDIARIO/CANAL - ADAPTADORES/INTERMEDIARIOS/PORTA-MATRIZES

ADAPTATEURS/INTERMÉDIAIRES/SEMELLES - ADAPTER/ZWISCHENSTÜCKE/MATRIZENADAPTERSCHIENEN

INTERMEDIARI FISSI

INTERMEDIARI FISSI - INTERMEDIATES - INTERMEDIARIO FIJOS - INTERMEDIÁRIOS - INTERMÉDIAIRES - ZWISCHENSTÜCKE

| | 1 | 2 | Mt |
|----|---|---|----|
| A= | | | |
| B= | | | |
| C= | | | |
| D= | | | |

INDICARE QUOTA - SPECIFY DIMENSION - INDICAR COTA - INDICAR COTA - INDIQUER LES COTES - MASSE ANGEVEN

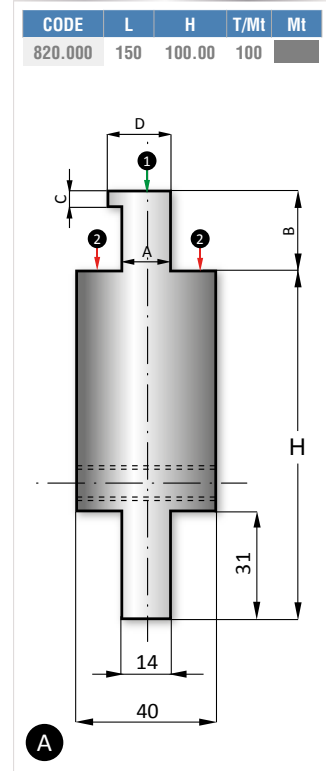
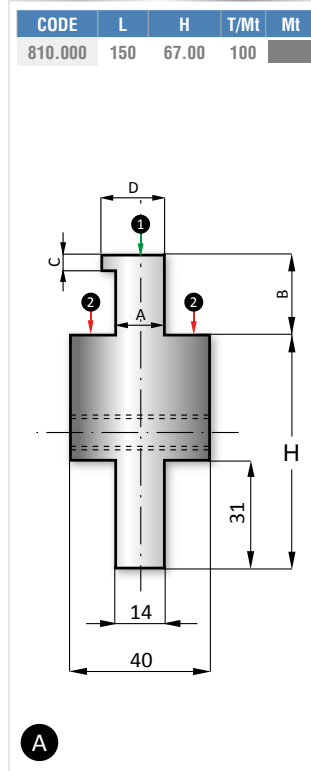
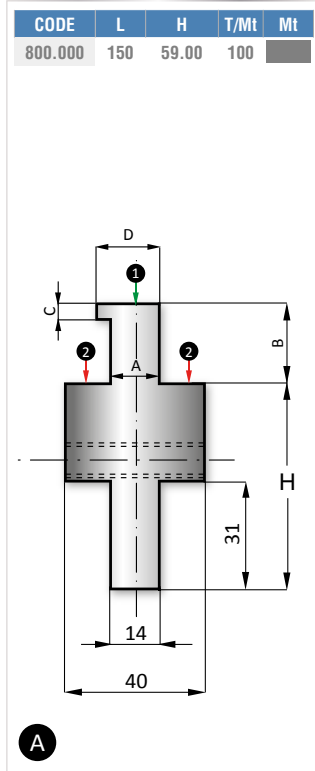

| CODE | L | T/Mt | Mt |
|--------|------|------|----|
| 60.680 | 2100 | 100 | |
| 60.681 | 2600 | 100 | |
| 60.682 | 3100 | 100 | |
| 60.683 | 4100 | 100 | |

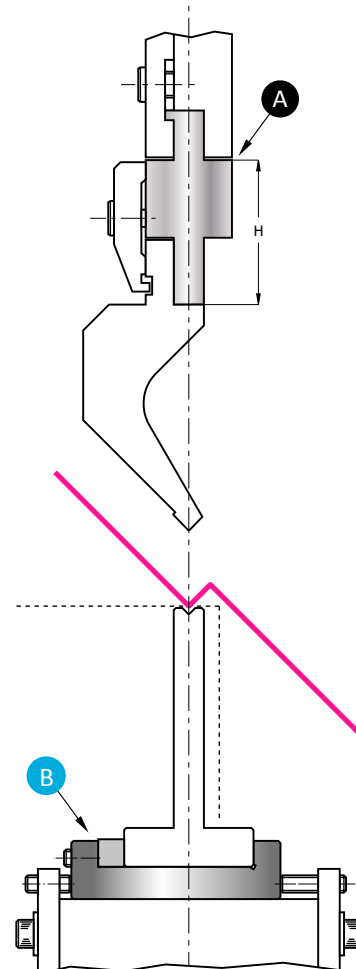
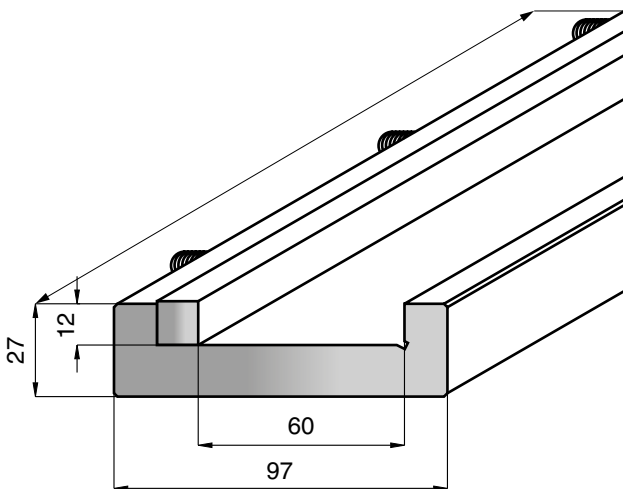

ADATTATORI TRUMPF / AMADA / BEYELER R / S / RF-A

ADATTATORI - ADAPTERS- ADAPTADORES - ADAPTADORES - ADAPTATEURS - ADAPTER

| CODE | L | H | T/Mt | Mt |
|--------|-----|-------|------|----|
| 50.430 | 150 | 67.00 | 100 | |

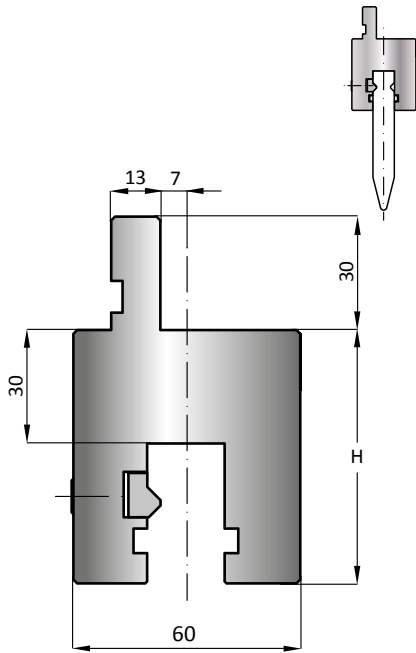

AMADA / WILA -TRUMPF

| CODE | L | H | T/Mt | Mt |
|--------|-----|-------|------|----|
| 50.980 | 150 | 67.00 | 100 | |

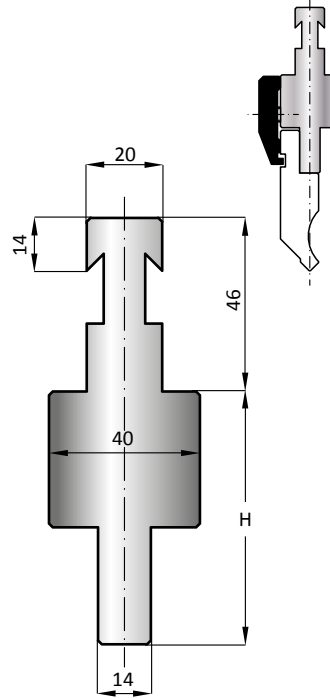

BEYELER-R / AMADA

| CODE | L | H | T/Mt | Mt |
|--------|-----|-------|------|----|
| 50.981 | 150 | 67.00 | 100 | |

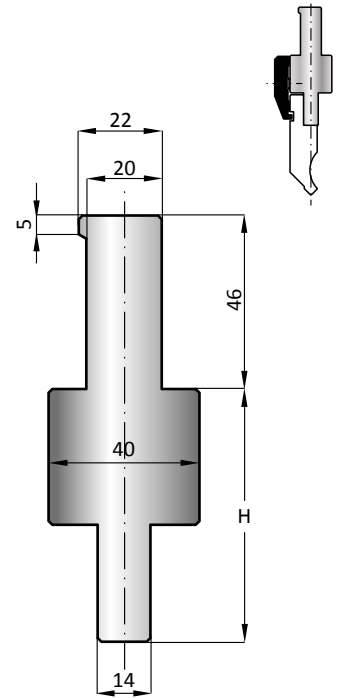

BEYELER-S / AMADA

| CODE | L | H | T/Mt | Mt |
|--------|-----|--------|------|----|
| 50.983 | 150 | 100.00 | 100 | |

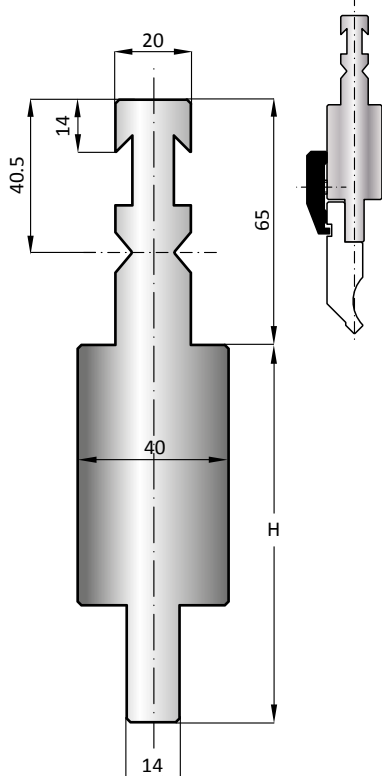

BEYELER RF-A / AMADA

| CODE | L | H | T/Mt | Mt |
|--------|-----|-------|------|----|
| 50.970 | 150 | 80.00 | 100 | |

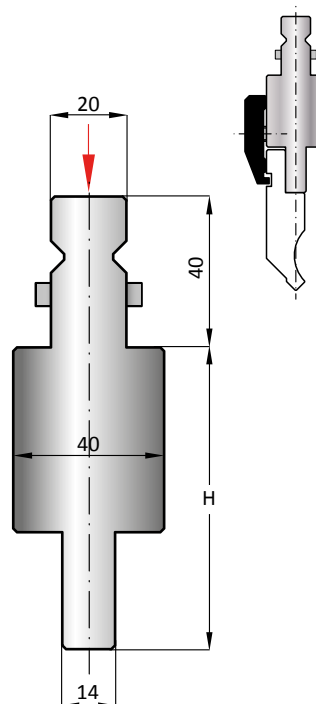

WILA -TRUMPF / AMADA

| CODE | L | H | T/Mt | Mt |
|--------|-----|--------|------|----|
| 50.940 | 150 | 120.00 | 100 | |

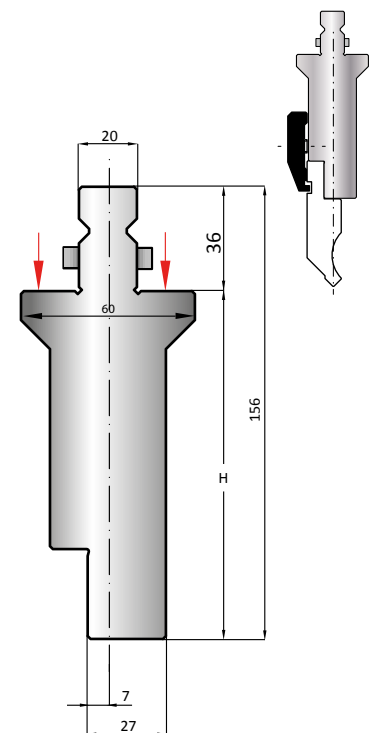

WILA -TRUMPF / AMADA

ADATTATORE EHT / LVD / WEINBRENNER / WILA / AMADA

ADATTATORI - ADAPTERS - ADAPTADORES - ADAPTADORES - ADAPTATEURS - ADAPTER

| CODE | L | H | T/Mt | Mt |
|--------|-----|-------|------|----|
| 50.990 | 150 | 80.00 | 100 | |

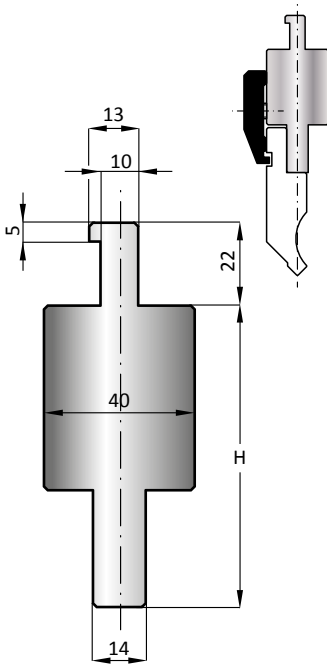

LVD / AMADA

| CODE | L | H | T/Mt | Mt |
|--------|-----|-------|------|----|
| 50.470 | 150 | 65.00 | 100 | |

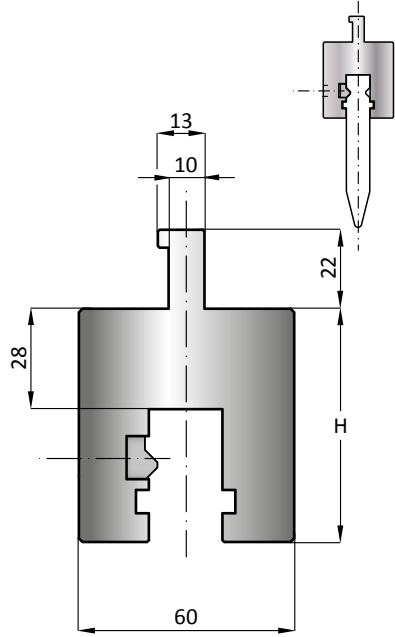

LVD / WILA -TRUMPF

| CODE | L | H | T/Mt | Mt |
|--------|-----|--------|------|----|
| 50.991 | 150 | 100.00 | 100 | |

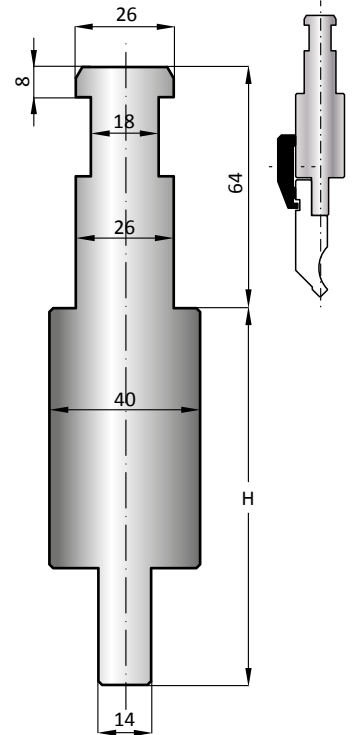

EHT / AMADA

| CODE | L | H | T/Mt | Mt |
|--------|-----|-------|------|----|
| 50.450 | 150 | 63.00 | 100 | |

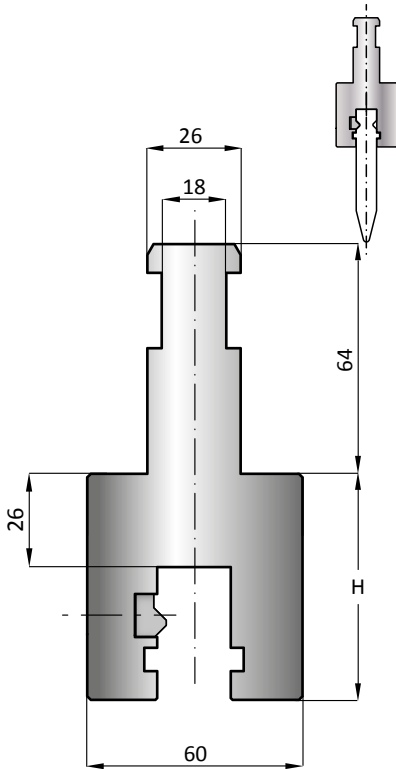

EHT / WILA -TRUMPF

| CODE | L | H | T/Mt | Mt |
|--------|-----|--------|------|----|
| 50.993 | 150 | 100.00 | 100 | |

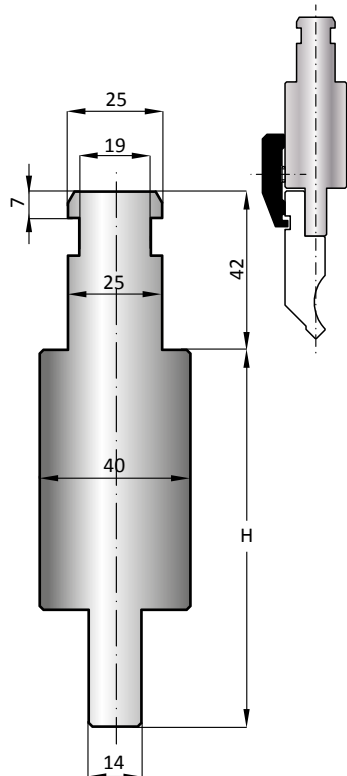

WEINBRENNER / AMADA

| CODE | L | H | T/Mt | Mt |
|--------|-----|-------|------|----|
| 50.490 | 150 | 65.00 | 100 | |

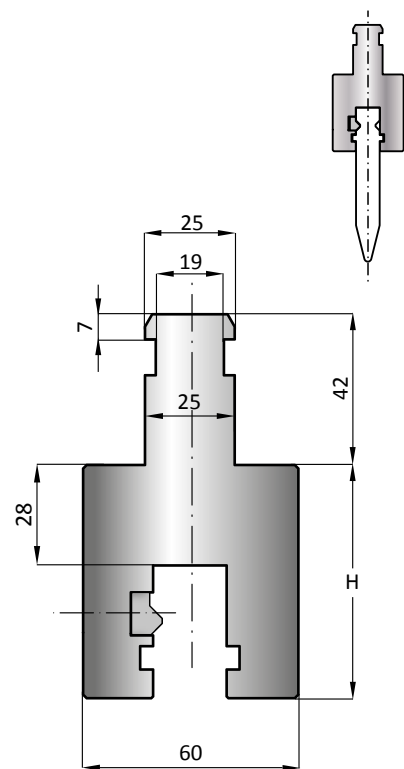

WEINBRENNER / WILA -TRUMPF

ADATTATORE DURMAZLAR / BAYKAL / HACO / DARLEY / AMADA

ADATTATORI - ADAPTERS - ADAPTADORES - ADAPTADORES - ADAPTATEURS - ADAPTER

| CODE | L | H | T/Mt | Mt |
|--------|-----|-------|------|----|
| 50.992 | 150 | 67.00 | 100 | |

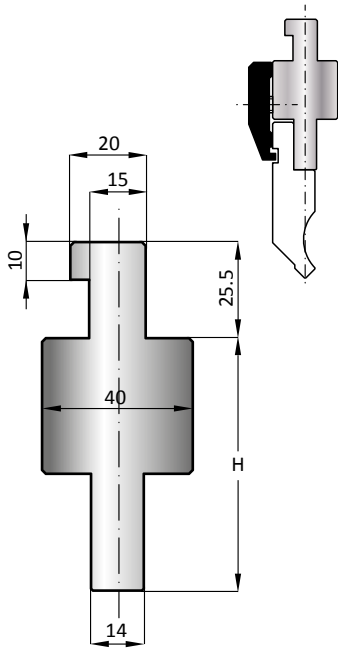

DURMAZLAR / AMADA

| CODE | L | H | T/Mt | Mt |
|--------|-----|-------|------|----|
| 50.996 | 150 | 89.00 | 100 | |

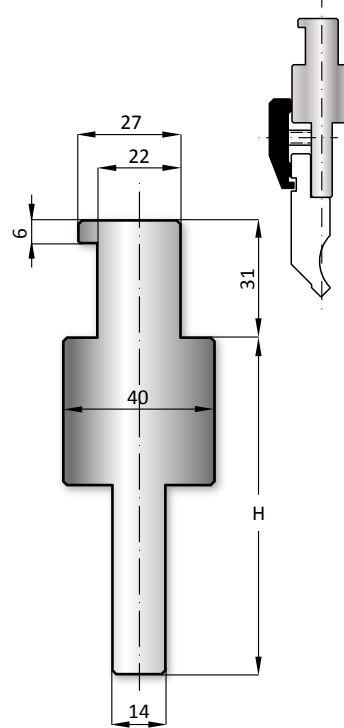

BAYKAL / AMADA

| CODE | L | H | T/Mt | Mt |
|--------|-----|-------|------|----|
| 50.998 | 150 | 67.00 | 100 | |

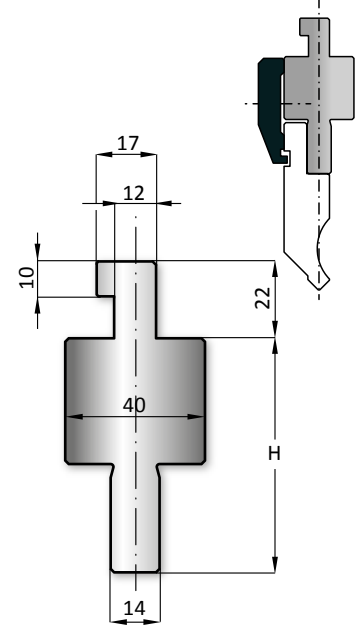

HACO / AMADA

| CODE | L | H | T/Mt | Mt |
|--------|-----|-------|------|----|
| 50.997 | 150 | 67.00 | 100 | |

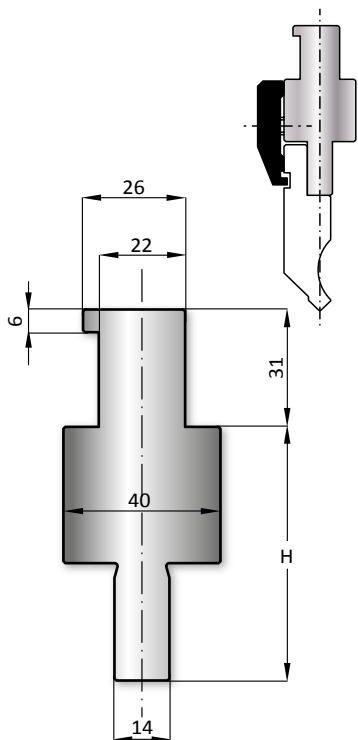

DARLEY / AMADA

| CODE | L | H | T/Mt | Mt |
|--------|-----|--------|------|----|
| 50.994 | 150 | 100.00 | 100 | |

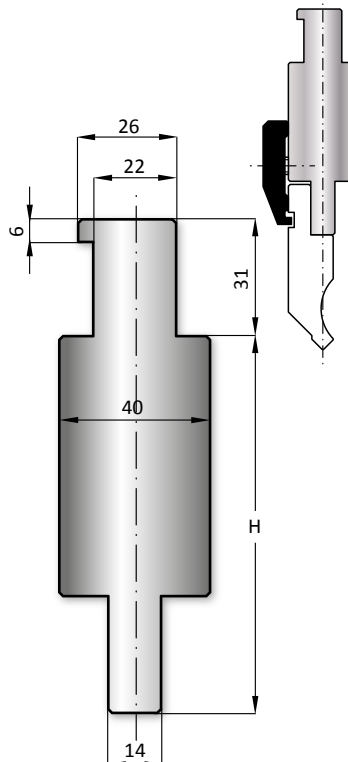

DARLEY / AMADA

| CODE | L | H | T/Mt | Mt |
|--------|-----|--------|------|----|
| 50.671 | 150 | 100.00 | 100 | |

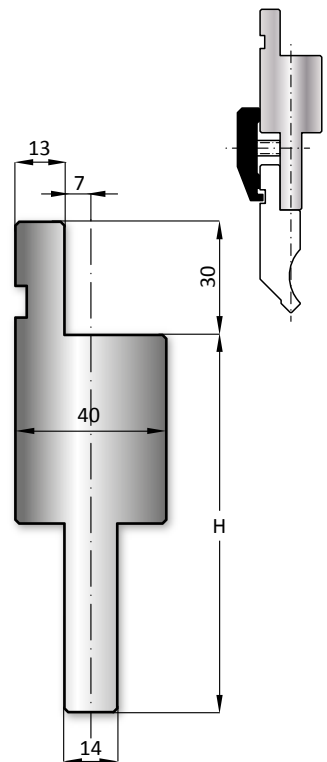

PROLUNGA - EXTENSION - EXTENSIÓN
EXTENSOR - EXTENSION - VERLÄNGERUNG

AMADA

ADATTATORE USA / EU / NEWTON

ADATTATORI - ADAPTERS - ADAPTADORES - ADAPTADORES - ADAPTATEURS - ADAPTER

| CODE | L | H | T/Mt | Mt |
|--------|-----|-------|------|----|
| 50.960 | 150 | 23.00 | 100 | |

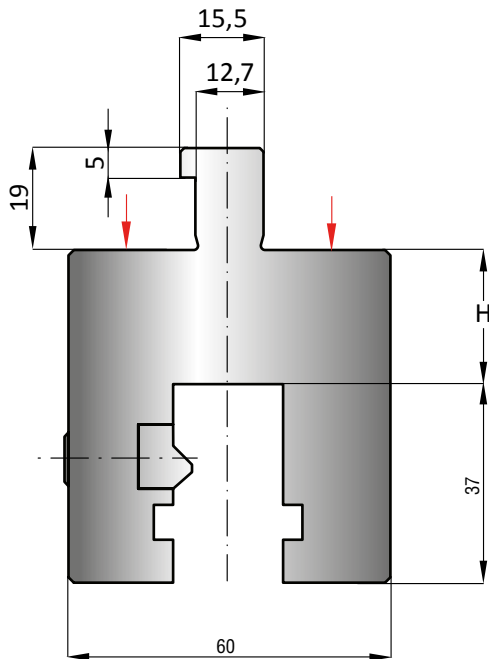

USA - EU / WILA ADAPTER

| CODE | L | H | T/Mt | Mt |
|--------|-----|-------|------|----|
| 50.950 | 150 | 67.00 | 100 | |

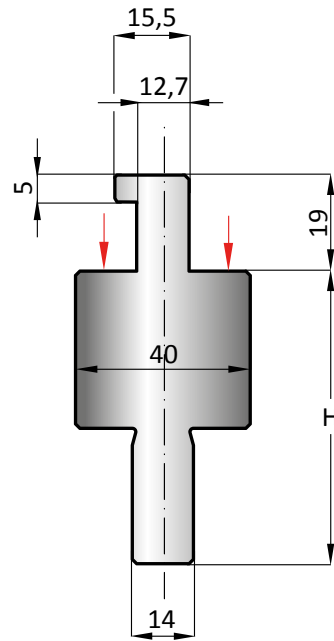

USA - EU / AMADA ADAPTER

| CODE | L | H | T/Mt | Mt |
|--------|-----|--------|------|----|
| 50.930 | 150 | 100.00 | 100 | |

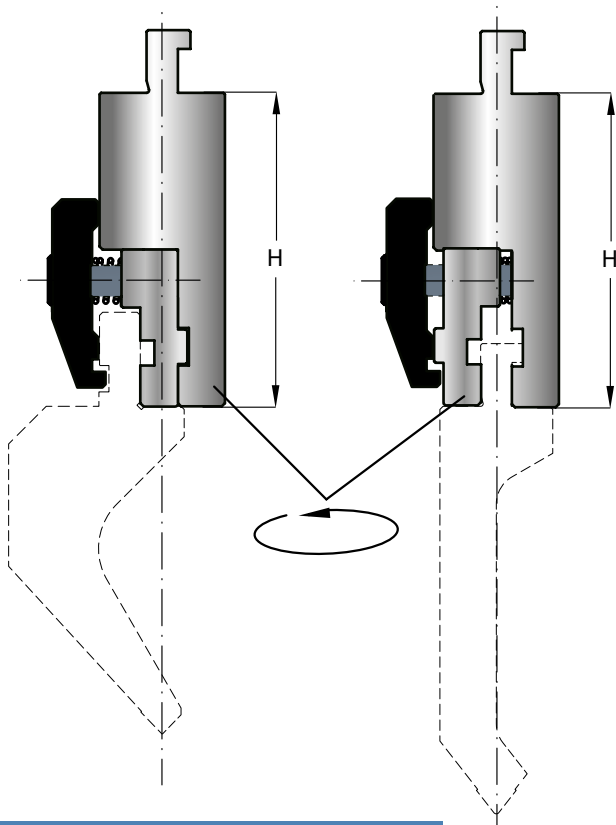

NEWTON / AMADA

| CODE | L | H | T/Mt | Mt |
|--------|-----|--------|------|----|
| 50.935 | 150 | 100.00 | 100 | |

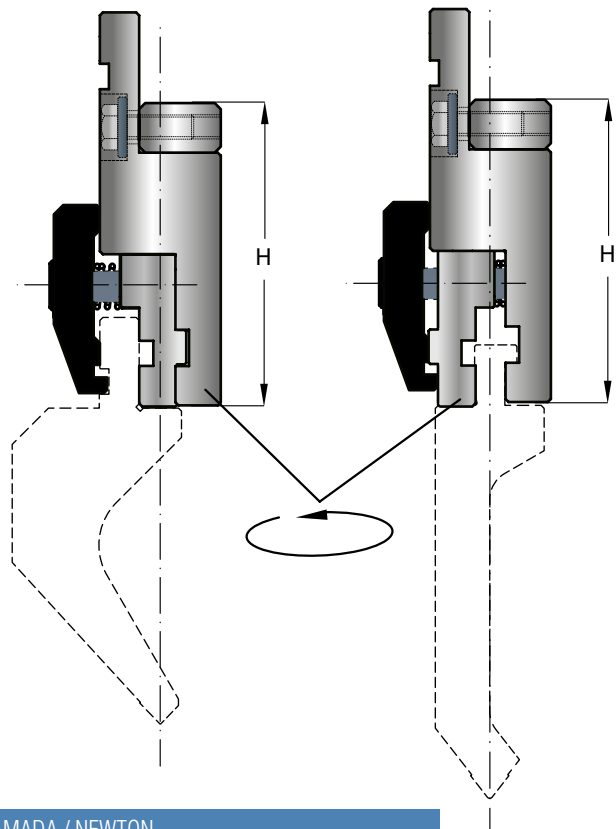

AMADA / NEWTON

PROLUNGA AMADA / BEYELER / R / RF-A

PROLUNGA - EXTENSION - EXTENSIÓN - EXTENSÃO - EXTENSION - VERLÄNGERUNG

| CODE | L | H | T/Mt | Mt |
|--------|-----|-------|------|----|
| 50.959 | 150 | 60.00 | 100 | |

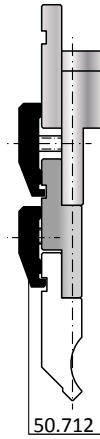
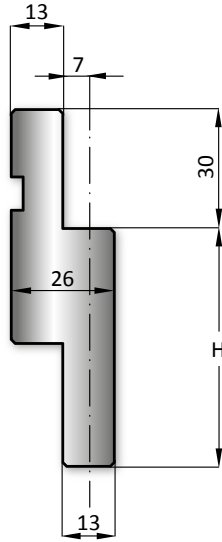

AMADA

| CODE | L | H | T/Mt | Mt |
|--------|-----|--------|------|----|
| 50.985 | 150 | 100.00 | 100 | |

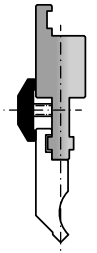
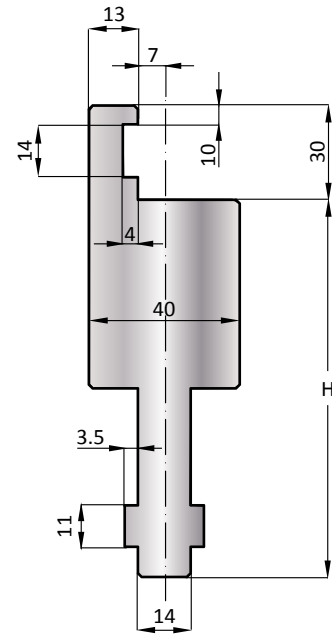

BEYELER

| CODE | L | H | T/Mt | Mt |
|--------|-----|--------|------|----|
| 50.982 | 150 | 101.00 | 100 | |

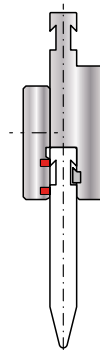
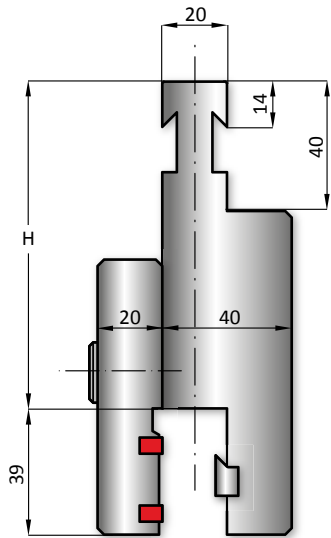

BEYELER - R

| CODE | L | H | T/Mt | Mt |
|--------|-----|--------|------|----|
| 50.400 | 150 | 100.00 | 100 | |

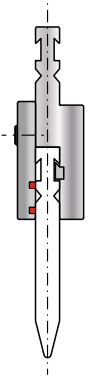
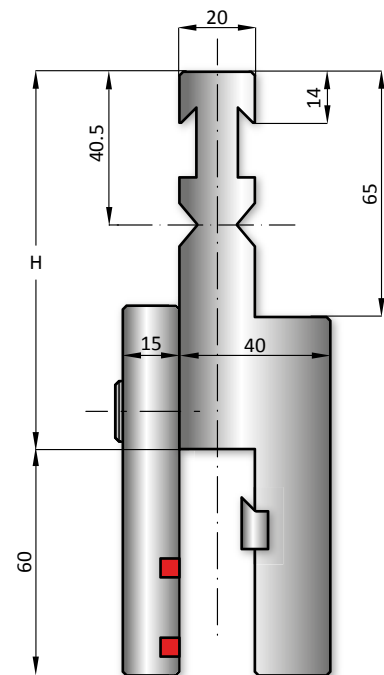

BEYELER RF-A

PROLUNGA WILA-TRUMPF

PROLUNGA - EXTENSION - EXTENSIÓN - EXTENSÃO - EXTENSION - VERLÄNGERUNG

| CODE | L | H | T/Mt | Mt |
|--------|-----|--------|------|----|
| 50.410 | 150 | 100.00 | 100 | |

WILA - TRUMPF

| CODE | L | H | T/Mt | Mt |
|--------|----|--------|------|----|
| 50.415 | 50 | 100.00 | 100 | |

WILA - TRUMPF

| CODE | L | H | T/Mt | Mt |
|--------|-----|--------|------|----|
| 50.440 | 150 | 150.00 | 100 | |

WILA - TRUMPF

| CODE | L | H | T/Mt | Mt |
|--------|----|--------|------|----|
| 50.445 | 50 | 150.00 | 100 | |

WILA - TRUMPF

PROLUNGA AMADA / WILA-TRUMPF

PROLUNGA - EXTENSION - EXTENSIÓN - EXTENSÃO - EXTENSION - VERLÄNGERUNG

| CODE | L | H | T/Mt | Mt |
|--------|-----|--------|------|----|
| 50.500 | 200 | 220.00 | 90 | |

AMADA

| CODE | L | H | T/Mt | Mt |
|--------|-----|--------|------|----|
| 50.501 | 200 | 220.00 | 90 | |

AMADA

| CODE | L | H | T/Mt | Mt |
|--------|-----|--------|------|----|
| 50.502 | 200 | 220.00 | 90 | |

ADATTATORE- ADAPTER - ADAPTADORE
ADAPTADORE - ADAPTATEUR - ADAPTER
WILA - TRUMPF / AMADA

| CODE | L | H | T/Mt | Mt |
|--------|-----|--------|------|----|
| 50.503 | 200 | 220.00 | 90 | |

WILA - TRUMPF

INTERMEDIARI REGISTRABILI AMADA / PROMECAM

ADATTATORI - ADAPTERS - ADAPTADORES - ADAPTADORES - ADAPTATEURS - ADAPTER
 PROLUNGA - EXTENSION - EXTENSIÓN - EXTENSÃO - EXTENSION - VERLÄNGERUNG

| CODE | L | H | T/Mt | Mt |
|--------|-----|--------|------|----|
| 50.666 | 150 | 100.00 | 100 | |
| 50.668 | 150 | 120.00 | 100 | |
| 50.512 | 150 | 150.00 | 100 | |

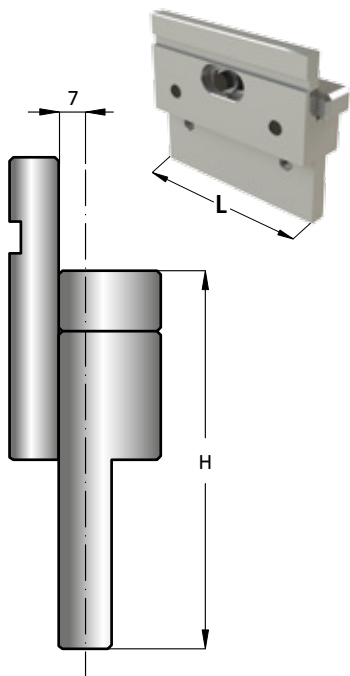

| CODE | L | H | T/Mt | Mt |
|--------|-----|--------|------|----|
| 50.674 | 150 | 120.00 | 100 | |

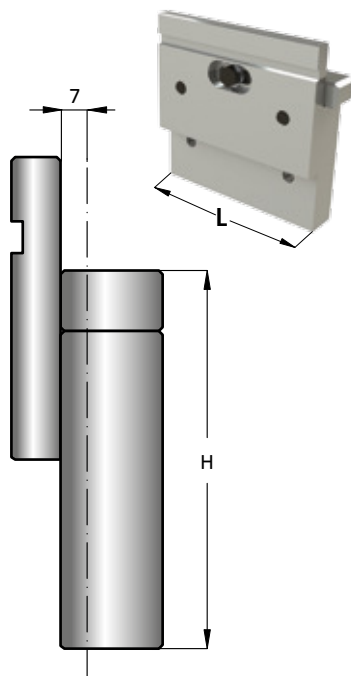

| CODE | L | H | T/Mt | Mt |
|--------|----|--------|------|----|
| 50.705 | 70 | 100.00 | 100 | |
| 50.706 | 70 | 120.00 | 100 | |
| 50.708 | 70 | 150.00 | 100 | |

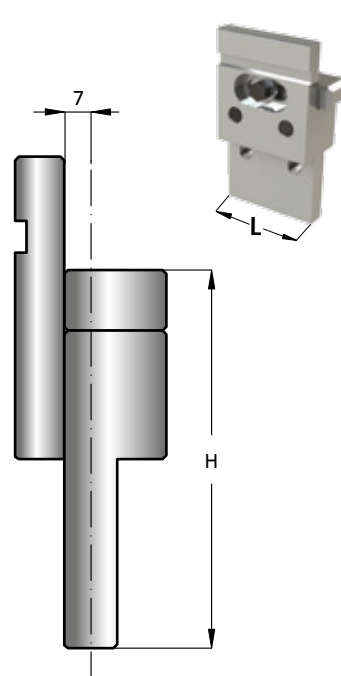

| CODE | L | H | T/Mt | Mt |
|--------|-----|--------|------|----|
| 50.667 | 150 | 120.00 | 100 | |
| 50.669 | 150 | 150.00 | 100 | |

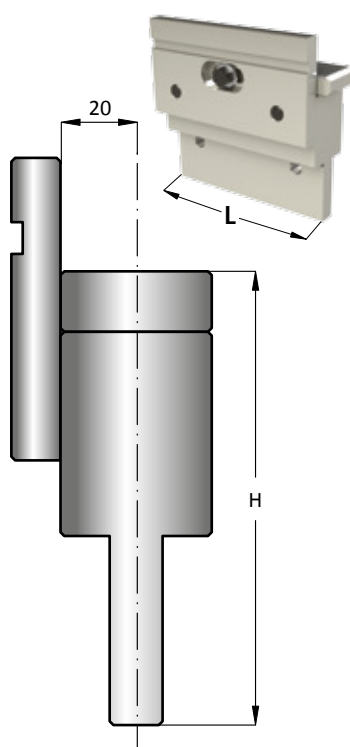

| CODE | L | H | T/Mt | Mt |
|--------|-----|--------|------|----|
| 50.673 | 150 | 120.00 | 100 | |

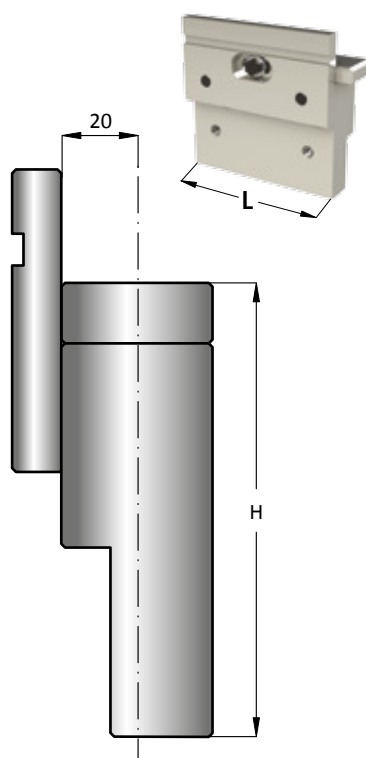

| CODE | L | H | T/Mt | Mt |
|--------|----|--------|------|----|
| 50.707 | 70 | 120.00 | 100 | |
| 50.710 | 70 | 150.00 | 100 | |

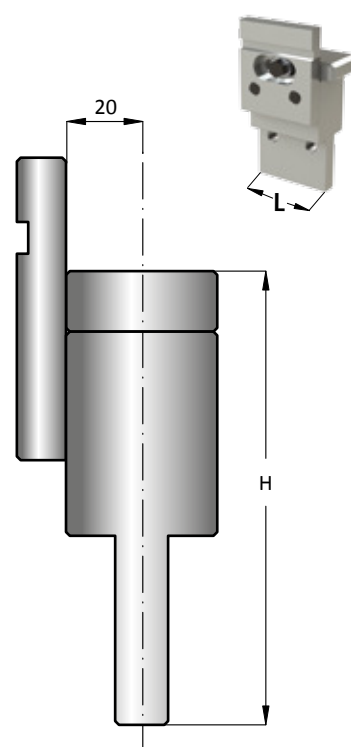

STAFFE NON COMPRESSE - CLAMP PLATES NOT INCLUDED - BRIDAS NO INCLUIDAS
 BARRAS NÃO INCLUÍDAS - BRIDES NON COMPRISES - OHNE KLEMMBRIDEN

INTERMEDIARI RAPIDI SWING

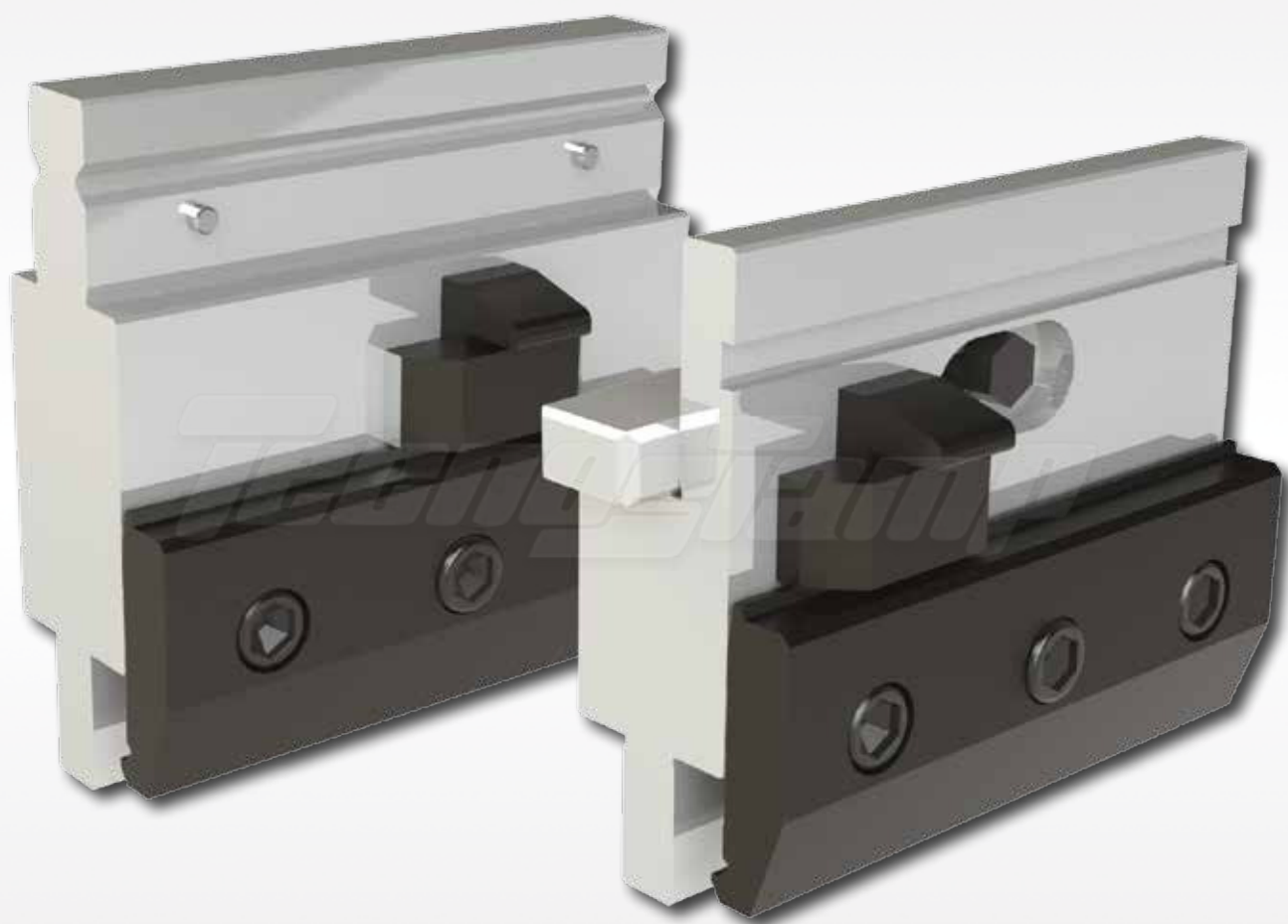

MAGENTA LINE

ADAPTERS FOR ALL PRESS BRAKES

INTERMEDIARIO RAPIDO MANUALE - MANUAL FAST CLAMPING

INTERMEDIARIO RÁPIDO - INTERMEDIÁRIO RÁPIDO MANUAL

INTERMÉDIAIRES RAPIDE MANUEL - ZWISCHENSTÜCK ZUR MANUELLEN SCHNELLKLEMMUNG

INTERMEDIARIO RAPIDO MANUALE AMADA / PROMECAM

INTERMEDIARIO RAPIDO MANUALE - FAST MANUAL CLAMPING - INTERMEDIARIO RÁPIDO

I INTERMEDIÁRIO RÁPIDO MANUAL - INTERMÉDIAIRES RAPIDE MANUEL - ZWISCHENSTÜCK ZUR MANUELLEN SCHNELLKLEMMUNG

SWING



PRINCIPIO DI FUNZIONAMENTO - FUNCTIONING INSTRUCTION - INSTRUCCIONES DE FUNCIONAMIENTO

PRINCÍPIO DE FUNCIONAMENTO - INSTRUCTIONS DE FONCTIONNEMENT - BETRIEBSANLEITUNG

| CODE | L | H | T/Mt | Mt |
|--------|-----|--------|------|----|
| 50.200 | 150 | 100.00 | 100 | |
| 50.210 | 150 | 120.00 | 100 | |
| 50.220 | 150 | 150.00 | 100 | |

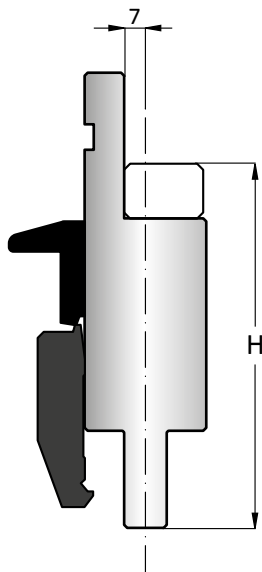

AMADA / PROMECAM

| CODE | L | H | T/Mt | Mt |
|--------|-----|--------|------|----|
| 50.250 | 150 | 150.00 | 100 | |

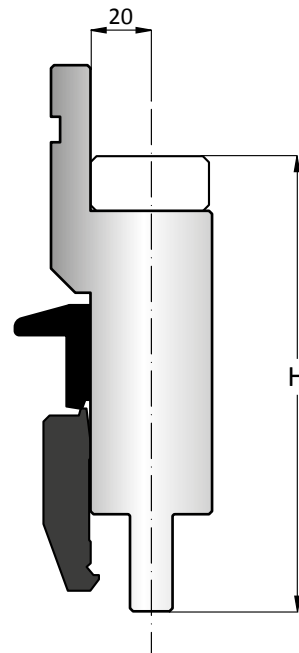

AMADA / PROMECAM

INTERMEDIARIO RAPIDIO MANUALE WILA / AMADA

INTERMEDIARIO RAPIDO MANUALE - FAST MANUAL CLAMPING - INTERMEDIARIO RÁPIDO

INTERMEDIÁRIO RÁPIDO MANUAL - INTERMÉDIAIRES RAPIDE MANUEL - ZWISCHENSTÜCK ZUR MANUELLEN SCHNELLKLEMMUNG

SWING



PRINCIPIO DI FUNZIONAMENTO - FUNCTIONING INSTRUCTION - INSTRUCCIONES DE FUNCIONAMIENTO

PRINCÍPIO DE FUNCIONAMENTO - INSTRUCTIONS DE FONCTIONNEMENT - BETRIEBSANLEITUNG

| CODE | L | H | T/Mt | Mt |
|--------|-----|--------|------|----|
| 50.972 | 150 | 105.00 | 100 | |

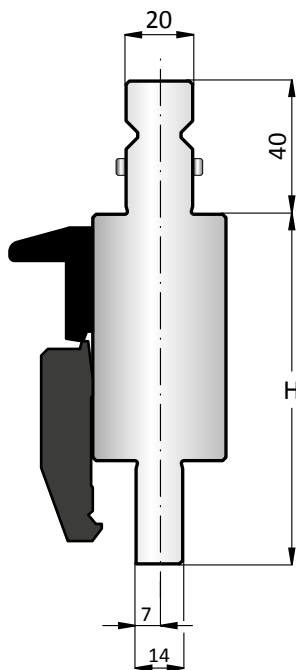

WILA / AMADA

| CODE | L | H | T/Mt | Mt |
|--------|-----|--------|------|----|
| 50.945 | 150 | 120.00 | 100 | |

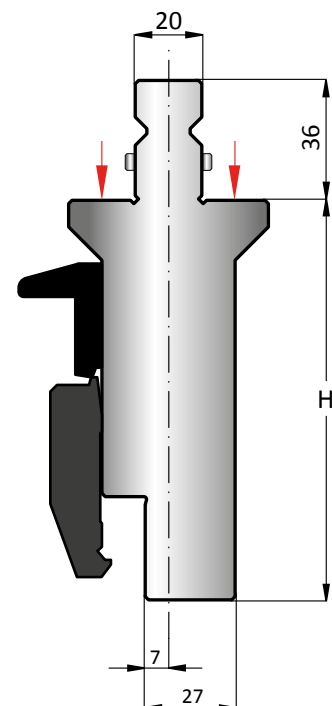

WILA / AMADA



STAFFE



MAGENTA LINE

ADAPTERS FOR ALL PRESS BRAKES

STAFFE - CLAMP PLATES - BRIDAS - BARRAS - BRIDES - KLEMMBRIDEN

STAFFE REGISTRABILI E FISSE L=150mm

STAFFE PER INTERMEDIARI REGISTRABILI E FISSI - CLAMP PLATES FOR ADAPTERS - BRIDAS PARA LOS INTERMEDIARIOS AJUSTABLES Y FIJOS

BARRAS PARA INTERMEDIÁRIOS AJUSTÁVEIS E FIXOS - BRIDES D'ATTACHE POUR INTERMÉDIAIRES FIXES ET RÉGLABLES - KLEMMBRIDEN FÜR ZWISCHENSTÜCKE UND VERSTELLBARE ZWISCHENSTÜCK

| CODE | L | H |
|--------|-----|-------|
| 50.529 | 150 | 50.00 |

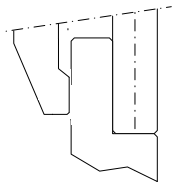

STAFFA
CLAMP PLATE
BRIDA
BARRAS
BRIDE
KLEMMBRIDEN

| CODE | L | H |
|--------|-----|-------|
| 50.571 | 150 | 60.00 |

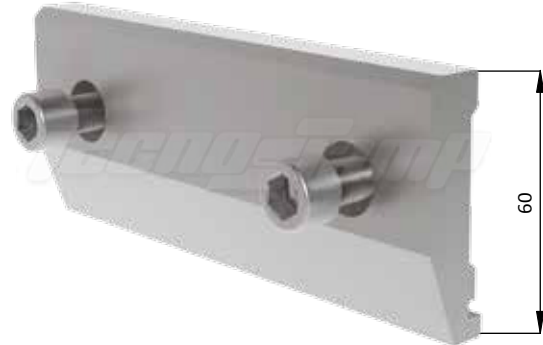
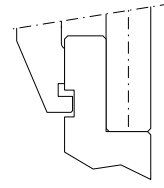

STAFFA DI SICUREZZA
SAFETY CLAMP PLATE
BRIDA DE SEGURIDAD
BARRAS DE SEGURANÇA
BRIDE AVEC RAINURE DE SÉCURITÉ
SICHERHEITSKLEMMBRIDE

| CODE | L | H |
|--------|-----|-------|
| 50.551 | 150 | 60.00 |

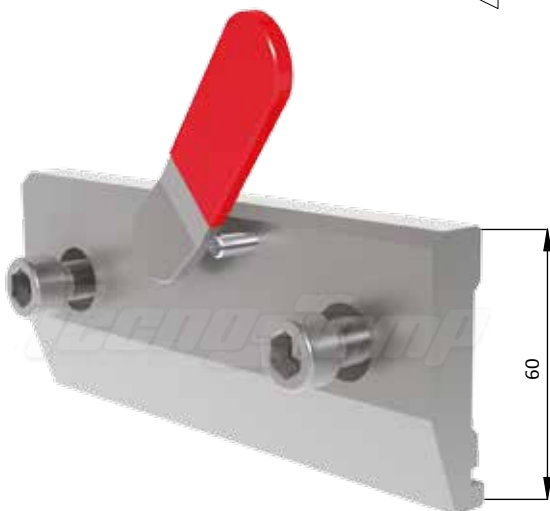
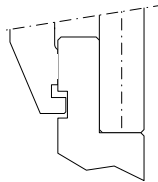

STAFFA DI SICUREZZA RAPIDA CON LEVETTA
QUICK SAFETY CLAMP PLATE
BRIDA DE SEGURIDAD CON PALANCA
BARRAS DE SEGURANÇA COM ALAVANCA
BRIDE A SERRAGE RAPIDE
SCHNELLKLEMM-SICHERHEITSKLEMMBRIDE

| CODE | L | H |
|--------|-----|-------|
| 50.900 | 150 | 60.00 |

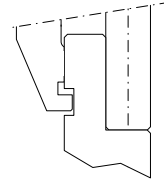

STAFFA DI SICUREZZA CON LEVETTA A SCOMPARSA
QUICK CLAMP PLATE WITH FOLDAWAY LEVER
BRIDA DE SEGURIDAD CON PALANCA ESCAMOTEABLE
BARRAS DE SEGURANÇA COM ALAVANCA RETRÁCTIL
BRIDE A SERRAGE RAPIDE LEVIER INTÉGRÉ
SICHERHEITSKLEMMBRIDE MIT VERSENKBAREM KLEMMHEBEL

STAFFE DI SICUREZZA CON INSERTO IN POLIURETANO

STAFFA DI SICUREZZA CON INSERTO IN POLIURETANO - SAFETY CLAMP WITH POLYURETHANE INSERT - BRIDA DE SEGURIDAD CON INSERTO EN POLIURETANO

BARRA DE SEGURANÇA COM INSERTO EM POLIURETANO - BRIDE AVEC INSERT POLYURETHANE - SCHNELLKLEMM-SICHERHEITSBRIDE MIT POLYURETHAN-EINLAGE

| CODE | L | H |
|--------|-----|-------|
| 50.910 | 150 | 60.00 |

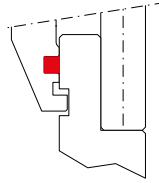

CON INSERTO IN POLIURETANO PER FRAZIONATI
WITH POLYURETHANE FOR SECTIONED UPPER TOOLS
CON INSERTO EN POLIURETANO PARA FRACCIONADOS
COM INSERTO EM POLIURETANO PARA FRACIONADOS
AVEC INSERT POLYURÉTHANE POUR FRACTIONNÉS
MIT POLYURETHAN-EINLAGE

| CODE | L | H |
|--------|-----|-------|
| 50.905 | 150 | 60.00 |

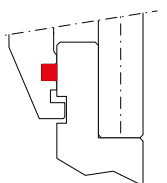

RAPIDA CON INSERTO IN POLIURETANO PER FRAZIONATI
QUICK SAFETY WITH POLYURETHANE FOR SECTIONED UPPER TOOLS
CON PALANCA CON INSERTO EN POLIURETANO PARA FRACCIONADOS
COM PALANCA CON INSERTO EM POLIURETANO PARA FRACIONADOS
AVEC INSERT POLYURÉTHANE POUR FRACTIONNÉS
MIT POLYURETHAN-EINLAGE

| CODE | L | H |
|--------|-----|-------|
| 50.903 | 150 | 60.00 |

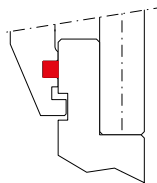

CON LEVETTA A SCOMPARSA ED INSERTO IN POLIURETANO
FOLDAWAY LEVER WITH POLYURETHANE
CON PALANCA ESCAMOTEABLE E INSERTO EN POLIURETANO
COM ALAVANCA RETRÁCTIL E INSERTO EM POLIURETANO
AVEC RAINURE DE SÉCURITÉ ET BARRETTE POLYURÉTHANE
MIT VERSENKBAREM KLEMMHEBEL UND POLYURETHAN-EINLAGE

TCEI M10X70

71.100

TCEI M10X35



CODE

50.574

50.551

50.529

50.577

50.905

50.571

50.900

50.910

50.903

50.310

50.712

50.697

50.693

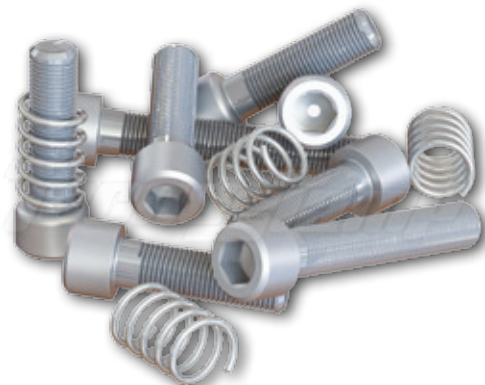

STAFFE REGISTRABILI E FISSE L=70mm / 150mm

STAFFE PER INTERMEDIARI FISSI - CLAMP PLATES FOR ADAPTERS - BRIDAS PARA LOS INTERMEDIARIOS FIJOS

BARRAS PARA INTERMEDIÁRIOS FIXOS - BRIDES POUR INTERMÉDIAIRES FIXES - KLEMMBRIDEN FÜR ZWISCHENSTÜCKE

| CODE | L | H |
|--------|-----|-------|
| 50.310 | 150 | 45.00 |

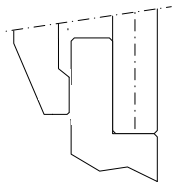

STAFFA
CLAMP PLATE
BRIDA
BARRAS
BRIDE
KLEMMBRIDE

| CODE | L | H |
|--------|-----|-------|
| 50.712 | 150 | 52.00 |

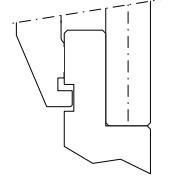

STAFFA DI SICUREZZA
SAFETY CLAMP PLATE
BRIDA DE SEGURIDAD
BARRAS DE SEGURANÇA
BRIDE AVEC RAINURE DE SÉCURITÉ
SICHERHEITSKLEMMBRIDE

STAFFE PER INTERMEDIARI REGISTRABILI - CLAMP PLATES FOR CENTERING ADAPTERS - BRIDAS PARA LOS INTERMEDIARIOS AJUSTABLES

BARRAS PARA INTERMEDIÁRIOS AJUSTÁVEIS - BRIDES POUR INTERMÉDIAIRES REGLABLES - KLEMMBRIDE FÜR VERSTELLBARE ZWISCHENSTÜCK

| CODE | L | H |
|--------|----|-------|
| 50.697 | 70 | 50.00 |

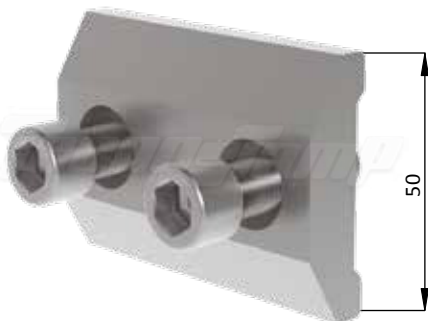
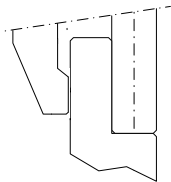

STAFFA
CLAMP PLATE
BRIDA
BARRAS
BRIDE
KLEMMBRIDE

| CODE | L | H |
|--------|----|-------|
| 50.693 | 70 | 60.00 |

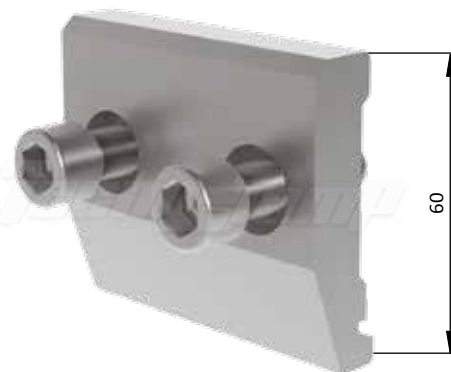
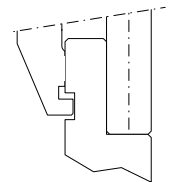

STAFFA DI SICUREZZA
SAFETY CLAMP PLATE
BRIDA DE SEGURIDAD
BARRAS DE SEGURANÇA
BRIDE AVEC RAINURE DE SÉCURITÉ
SICHERHEITSKLEMMBRIDE

KIT DOPPIO STAFFAGGIO

KIT PER DOPPIO STAFFAGGIO - EQUIPMENT FOR DOUBLE CLAMPING PLATE - KIT PARA DOBLE AMARRE

KIT PARA APERTO DUPLO - KIT POUR DOUBLE BRIDAGE - SET FÜR BEIDSEITIGE WERKZEUGKLEMMUNG

CODE

50.574

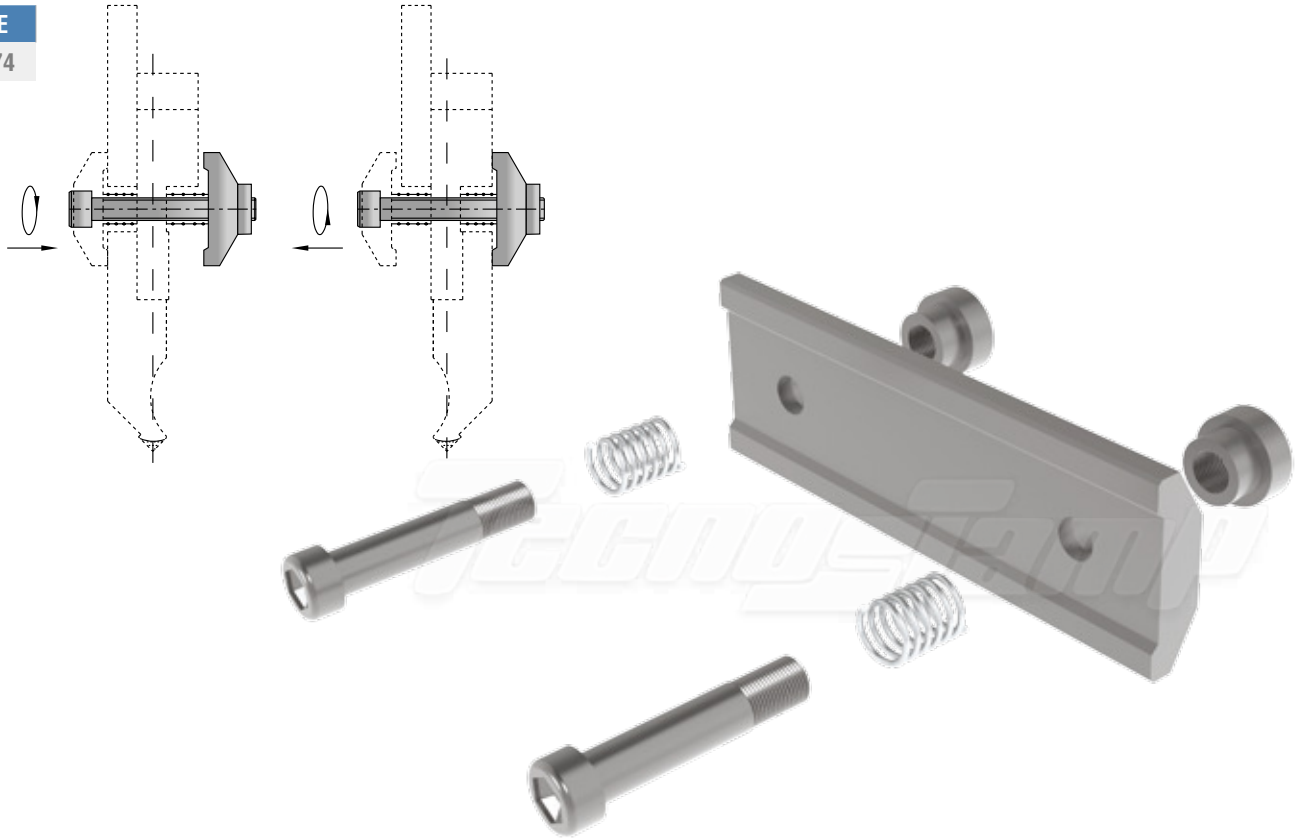

KIT PER DOPPIO STAFFAGGIO - EQUIPMENT FOR DOUBLE CLAMPING PLATE - KIT PARA DOBLE AMARRE

KIT PARA APERTO DUPLO - KIT POUR DOUBLE BRIDAGE - SET FÜR BEIDSEITIGE WERKZEUGKLEMMUNG

CODE

50.577

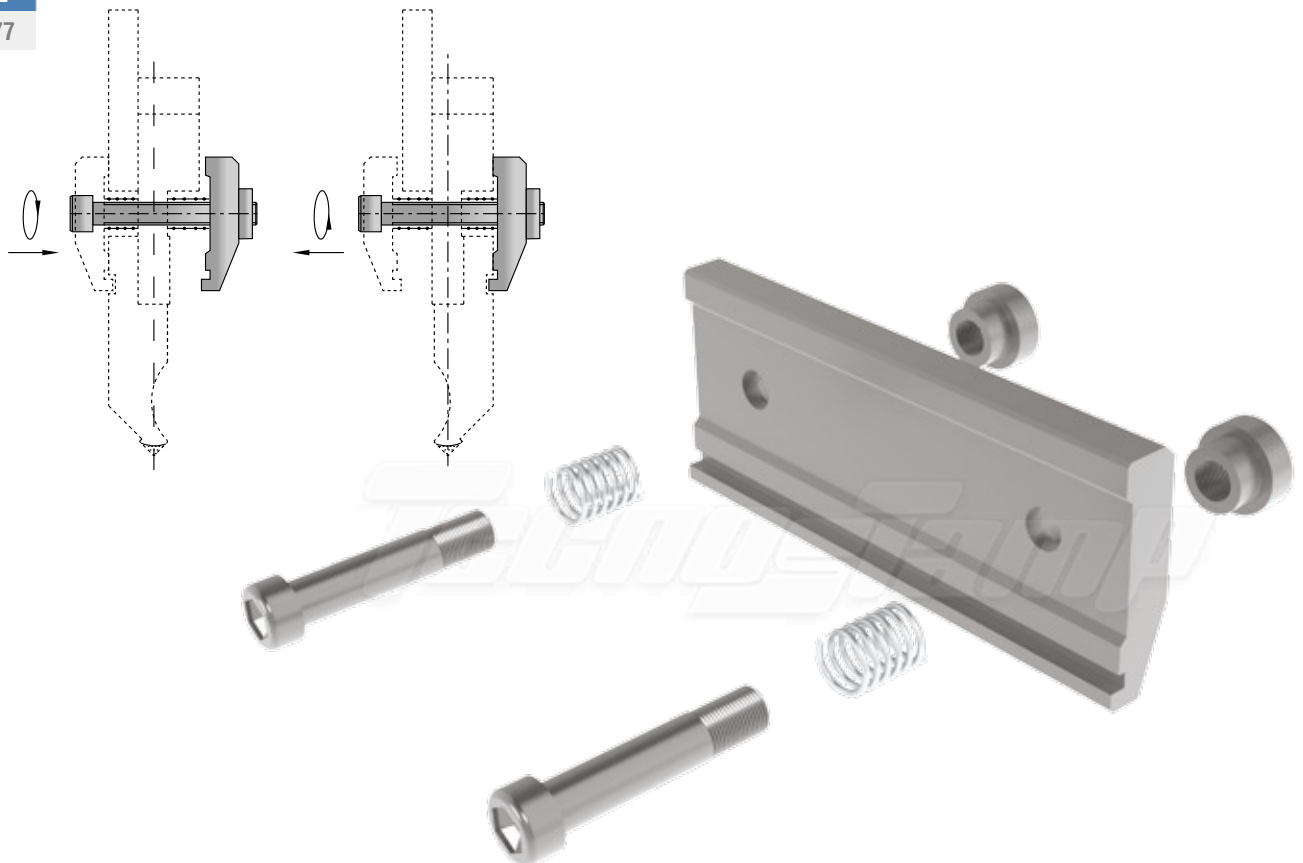



ADATTATORI INFERIORI



MAGENTA LINE

ADAPTERS FOR ALL PRESS BRAKES

ADATTATORI INFERIORI - LOWER ADAPTERS - ADAPTADORES INFERIOR

ADAPTADOR INFERIOR - ADAPTATEURS INFERIEURS - MATRIZENADAPTER

ADATTATORE INFERIORE AMADA / TRUMPF / LVD

ADATTATORE INFERIORE - LOWER ADAPTER - ADAPTADORE INFERIOR - ADAPTADOR INFERIOR - ADAPTATEURS INFERIEURS - MATRIZENADAPTER

| CODE | L | H | T/Mt | Mt |
|--------|------|-------|------|----|
| 60.910 | 1000 | 30.00 | 100 | |

AMADA / BEYELER - TRUMPF

| CODE | L | H | T/Mt | Mt |
|--------|------|-------|------|----|
| 60.920 | 1000 | 60.00 | 100 | |

AMADA / BEYELER - TRUMPF

| CODE | L | H | T/Mt | Mt |
|--------|------|-------|------|----|
| 60.935 | 1000 | 30.00 | 100 | |

LVD / BEYELER - TRUMPF

| CODE | L | H | T/Mt | Mt |
|--------|-----|-------|------|----|
| 60.960 | 500 | 50.00 | 100 | |

PROLUNGA - EXTENSION - EXTENSIÓN
EXTENSÃO - EXTENSION - VERLÄNGERUNG

WILA / TRUMPF

ADATTATORE INFERIORE AMADA / TRUMPF / BEYELER/ USA

ADATTATORE INFERIORE - LOWER ADAPTER - ADAPTADORE INFERIOR - ADAPTADOR INFERIOR - ADAPTEURS INFERIEURS - MATRIZENADAPTER

| CODE | L | H | T/Mt | Mt |
|--------|-----|-------|------|----|
| 60.925 | 835 | 40.00 | 100 | |

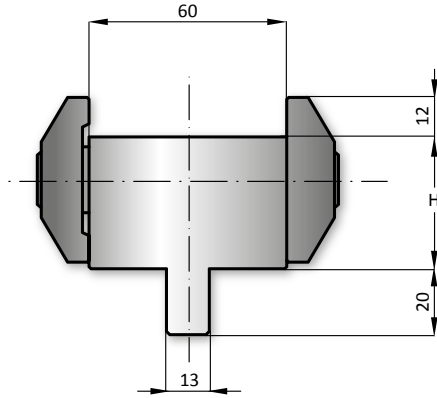
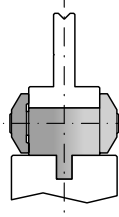

BEYELER - TRUMPF / AMADA

| CODE | L | H | T/Mt | Mt |
|--------|-----|-------|------|----|
| 60.930 | 835 | 40.00 | 100 | |

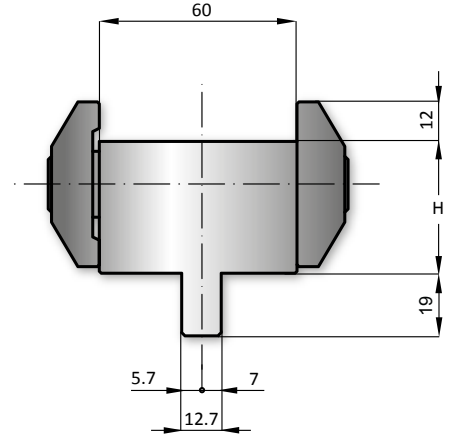
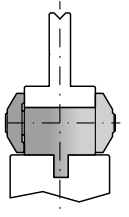

BEYELER - TRUMPF / AMADA

| CODE | L | H | T/Mt | Mt |
|--------|-----|-------|------|----|
| 60.919 | 835 | 55.00 | 100 | |

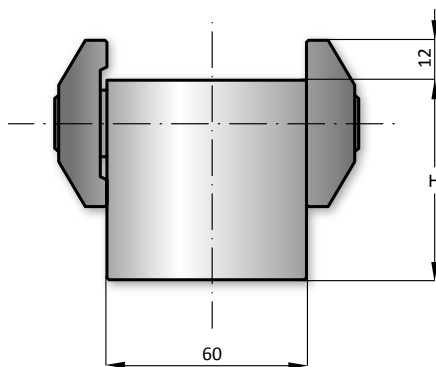
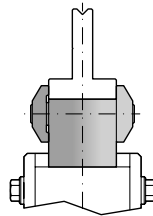

PROLUNGA - EXTENSION - EXTENSIÓN
EXTENSÃO - EXTENSION - VERLÄNGERUNG

AMADA / PROMECAM

| CODE | L | H | T/Mt | Mt |
|--------|-----|-------|------|----|
| 60.980 | 835 | 35.00 | 100 | |

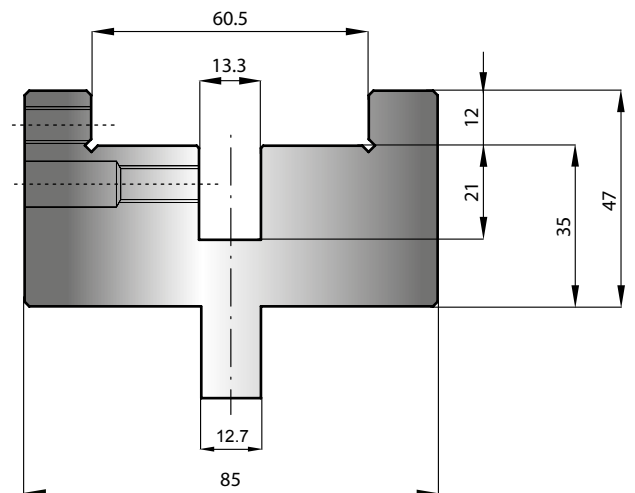

USA - EU / WILA -AMADA

ADATTATORE INFERIORE AMADA / TRUMPF / WEINBRENNER / EHT

ADATTATORE INFERIORE - LOWER ADAPTER - ADAPTADORE INFERIOR - ADAPTADOR INFERIOR - ADAPTEURS INFERIEURS - MATRIZENADAPTER

| CODE | L | H | T/Mt | Mt |
|--------|-----|-------|------|----|
| 60.940 | 500 | 40.00 | 100 | |

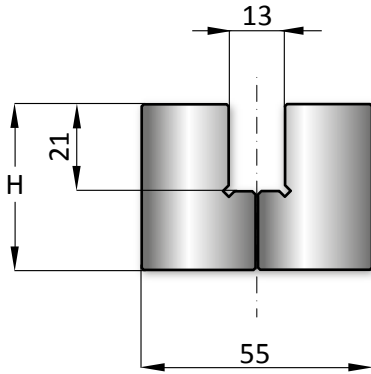
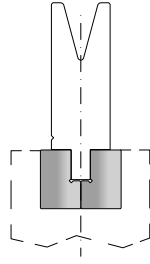

EHT / WILA

| CODE | L | H | T/Mt | Mt |
|--------|-----|-------|------|----|
| 60.950 | 500 | 45.00 | 100 | |

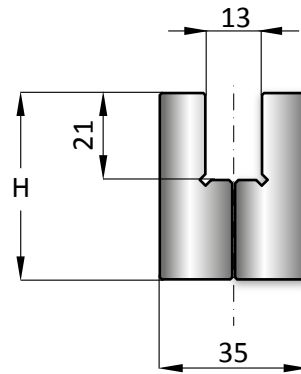
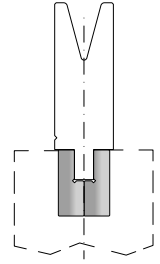

WEINBRENNER / WILA

| CODE | L | H | T/Mt | Mt |
|--------|-----|-------|------|----|
| 60.945 | 835 | 60.00 | 100 | |

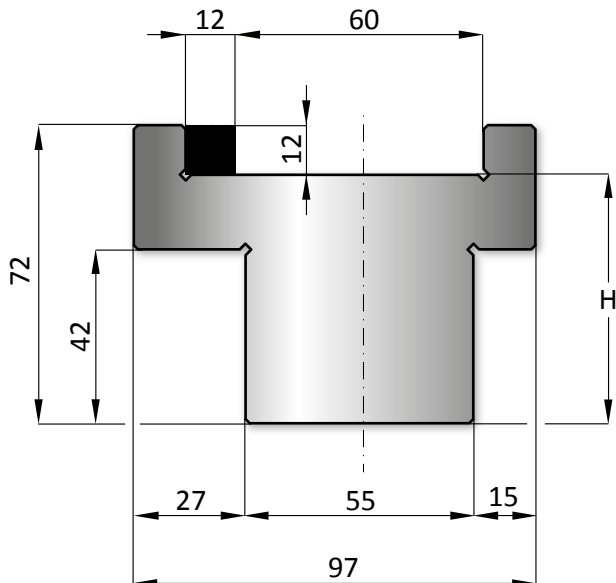
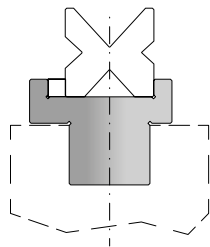

EHT / AMADA

| CODE | L | H | T/Mt | Mt |
|--------|-----|-------|------|----|
| 60.955 | 835 | 65.00 | 100 | |

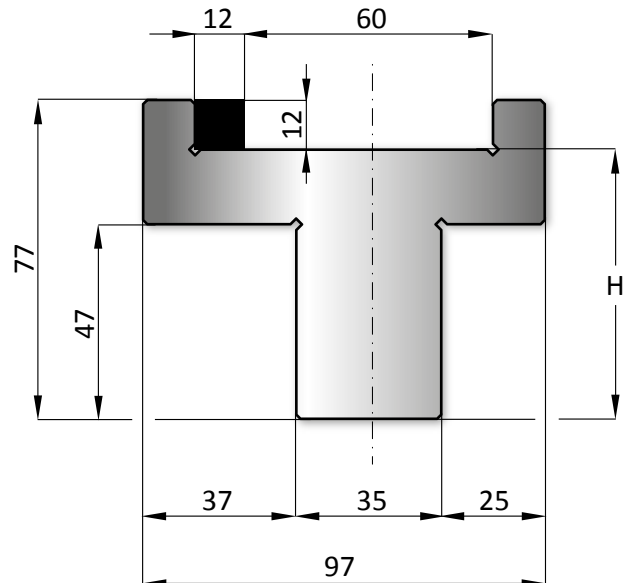
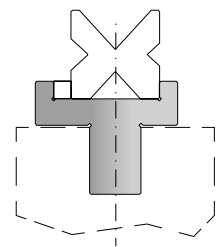

WEINBRENNER / AMADA

CANALINE MODULARI

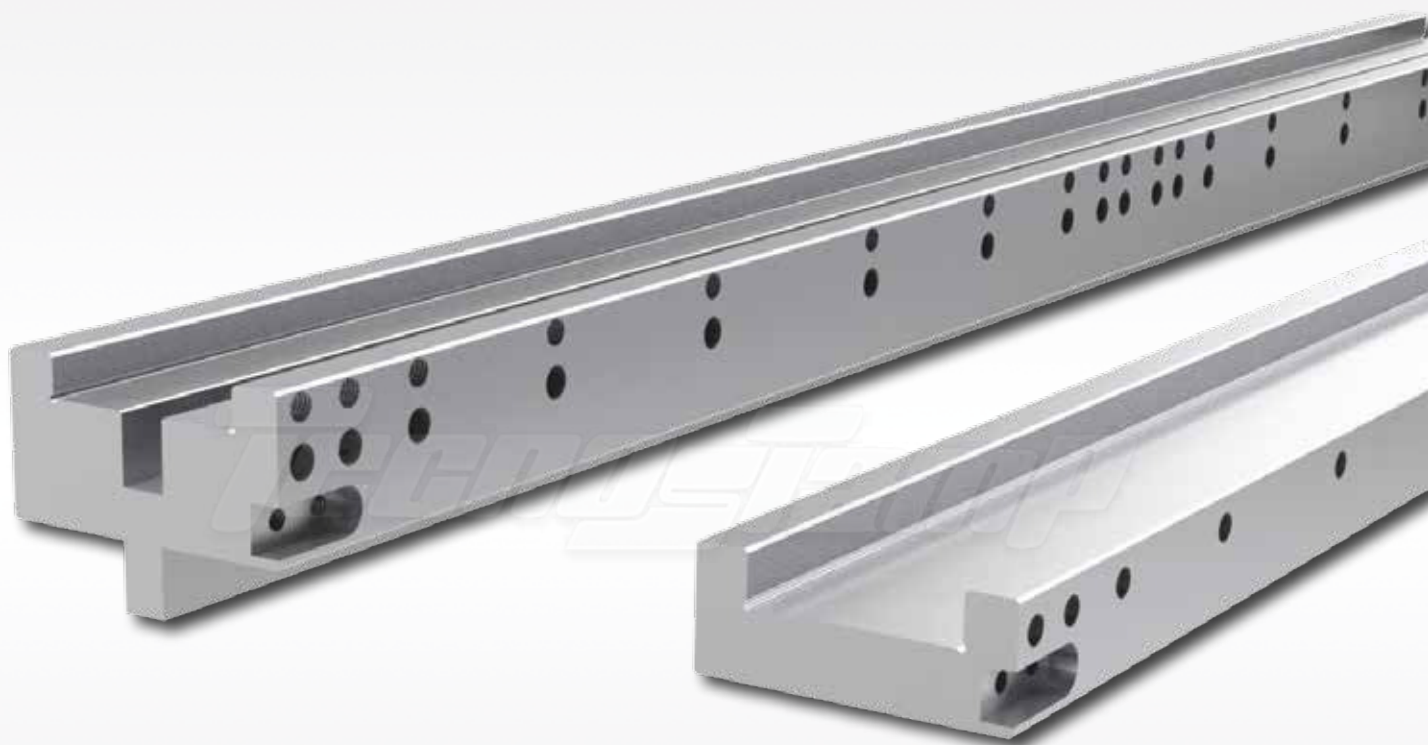

MAGENTA LINE

ADAPTERS FOR ALL PRESS BRAKES

**CANALINE MODULARI - MODULAR HOLDERS - CANAL MODULAR - PORTA-MATRIZ MODULAR
SEMELLE PORTE-MATRICES MODULABLE - MATRIZENADAPTERSCHIENEN MODULAR**

CANALINA MODULARE

| CODE | L | H | T/Mt | Mt |
|--------|------|-------|------|---|
| 60.710 | 1050 | 35.00 | 100 |  |

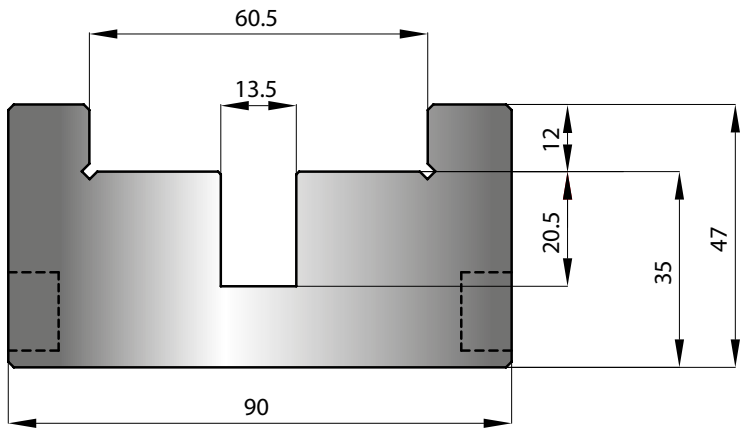

LENGTH | 1050



| CODE | L | H | T/Mt | Mt |
|--------|------|-------|------|---|
| 60.720 | 1050 | 20.00 | 100 |  |

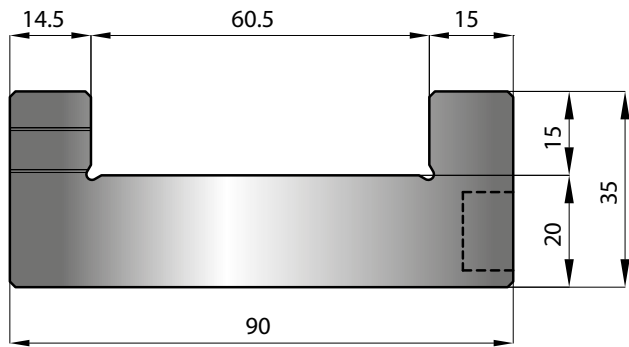

LENGTH | 1050



| CODE | L | H | T/Mt | Mt |
|--------|------|-------|------|---|
| 60.730 | 1050 | 20.00 | 100 |  |

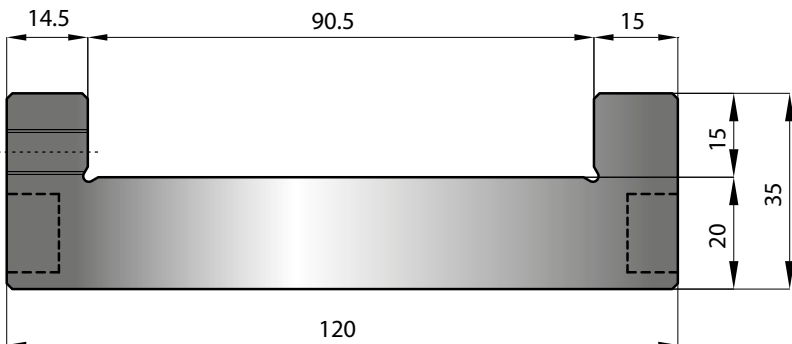

LENGTH | 1050



CANALINA MODULARE

| CODE | L | H | T/Mt | Mt |
|--------|------|-------|------|----|
| 60.715 | 1050 | 35.00 | 100 | |

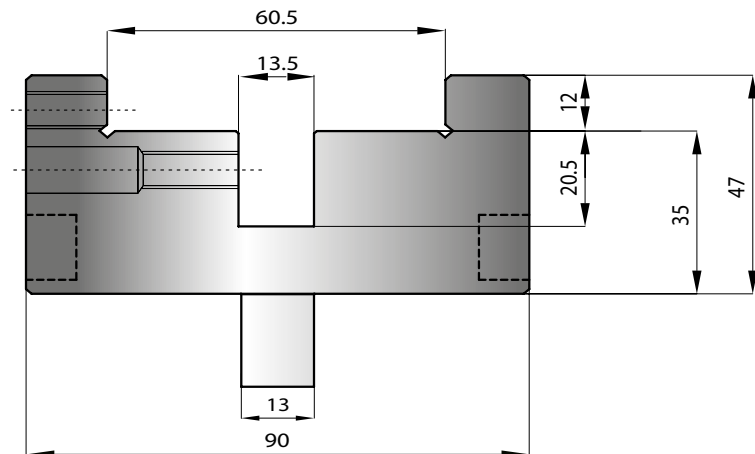

LENGTH 1050

| CODE | L | H | T/Mt | Mt |
|--------|------|-------|------|----|
| 60.725 | 1050 | 20.00 | 100 | |

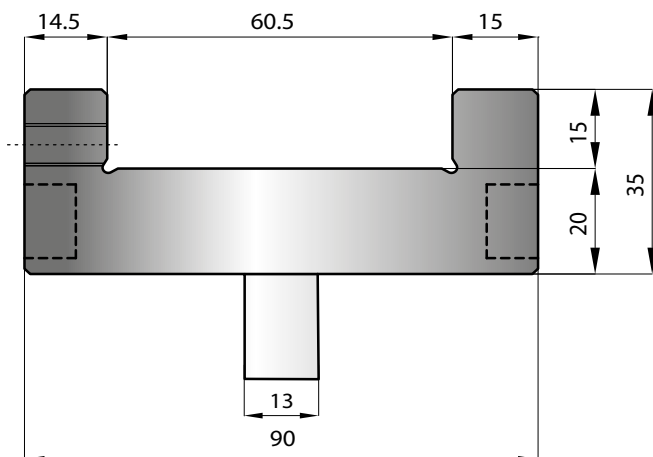

LENGTH 1050

| CODE | L | H | T/Mt | Mt |
|--------|------|-------|------|----|
| 60.735 | 1050 | 20.00 | 100 | |

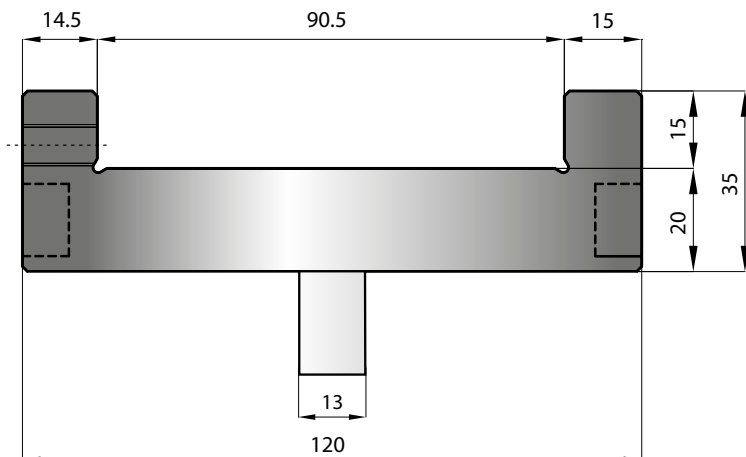

LENGTH 1050



RAPID CLARK



MAGENTA LINE

ADAPTERS FOR ALL PRESS BRAKES

INTERMEDIARI PNEUMATICI - PNEUMATIC INTERMEDIATES - AMARRE NEUMÁTICO

INTERMEDIÁRIO PNEUMÁTICO - INTERMÉDIAIRE PNEUMATIQUE - PNEUMATISCHE WERKZEUGKLEMMUNG

INTERMEDIARIO PNEUMATICO AMADA / PROMECAM

BLOCCAGGI PNEUMATICI PER CAMBIO RAPIDO UTENSILI - PNEUMATIC CLAMPING FOR FAST CHANGING TOOLS

AMARRE NEUMÁTICO PARA CAMBIO DE UTILLAJE - APERTO PNEUMÁTICO PARA MUDANÇA/TROCA RÁPIDA DE FERRAMENTAS

BLOCAGES PNEUMATIQUES POUR CHANGEMENT RAPIDE D'OUTILS - PNEUMATISCHE WERKZEUGKLEMMUNG FÜR DEN SCHNELLEN WERKZEUGWECHSEL

RAPID

| | |
|----------------|---|
| SERIE "RAPID" | PER UTENSILI SUPERIORI CON SCANALATURA AMADA 8.4X3mm (70.946) |
| "RAPID" SERIES | FOR UPPER TOOLS ONLY WITH AMADA SAFETY GROOVE 8.4X3mm (70.946) |
| SERIE "RAPID" | PARA UTILLAJES SUPERIORES CON ACANALADO STANDARD DE SEGURIDAD 8.4X3mm (70.946) |
| SÉRIE "RAPID" | PARA FERRAMENTAS SUPERIORES COM RANHURA DE SEGURANÇA AMADA 8.4X3mm (70.946) |
| SERIE "RAPID" | POUR OUTILS SUPÉRIEURS AVEC RAINURE DE SÉCURITÉ STANDARD AMADA 8.4X3mm (70.946) |
| "RAPID" SERIE | FÜR OBERWERKZEUGE MIT AMADA-NUT 8,4X3mm (70.946) |



CLARK

| | |
|----------------|--|
| SERIE "CLARK" | PER UTENSILI SUPERIORI CON SCANALATURA DI SICUREZZA DOPPIA (70.1050) |
| "CLARK" SERIES | FOR UPPER TOOLS ONLY WITH DOUBLE SAFETY GROOVE (70.1050) |
| SERIE "CLARK" | PARA UTILLAJES SUPERIORES CON ACANALADO DOBLE DE SEGURIDAD (70.1050) |
| SÉRIE "CLARK" | PARA FERRAMENTAS SUPERIORES COM RANHURA DUPLA DE SEGURANÇA (70.1050) |
| SERIE "CLARK" | POUR OUTILS SUPÉRIEURS AVEC DOUBLE RAINURE DE SÉCURITÉ (70.1050) |
| "CLARK" SERIE | FÜR OBERWERKZEUGE MIT DOPPELTER SICHERHEITSNUTE (70.1050) |



TAVOLE E STAFFE INFERIORI PNEUMATICHE, A RICHIESTA BLOCCAGGI PNEUMATICI ED IDRAULICI PER TUTTI I TIPI DI PRESSE PIEGATRICI

PNEUMATIC LOWER CLAMPS AND DIE HOLDER TABLES, ON REQUEST WE MANUFACTURE PNEUMATIC AND HYDRAULIC CLAMPING FOR ALL KINDS OF PRESS-BRAKES

MESAS Y BRIDAS INFERIORES NEUMÁTICAS, SOBRE PEDIDO FABRICAMOS SISTEMAS DE AMARRE NEUMÁTICOS E HIDRÁULICOS PARA TODO TIPO DE PLEGADORAS

MESAS E BARRAS INFERIORES PNEUMÁTICAS, A PEDIDO, APERTOS PNEUMÁTICOS E HIDRÁULICOS PARA TODO O TIPO DE QUINADORAS/DOBRADREIRAS

TABLES ET BRIDES INFÉRIEURES PNEUMATIQUES, A LA DEMANDE BLOCAGES PNEUMATIQUES ET HYDRAULIQUES POUR TOUS TYPES DE PRESSES PLIEUSES

PNEUMATISCHE UND HYDRAULISCHE MATRIZENAUFNAHME UND KLEMMUNG FÜR ALLE ABKANTPRESSEN AUF ANFRAGE



CENTRALINA PNEUMATICA

CENTRALINA PNEUMATICA PER LINEE SUPERIORI ED INFERIORI DI BLOCCAGGI PNEUMATICI

PNEUMATIC EQUIPMENT FOR UPPER AND LOWER PNEUMATIC LINES

CENTRAL NEUMÁTICA PARA UTILLAJES SUPERIORES E INFERIORES DE BLOQUEO NEUMÁTICO

UNIDADE PNEUMÁTICA PARA FERRAMENTAS SUPERIORES E INFERIORES DE BLOQUEIO PNEUMÁTICO

CENTRALE PNEUMATIQUE POUR LIGNES SUPÉRIEURES ET INFÉRIEURES DE BLOCAGES PNEUMATIQUES

STEUEREINHEIT FÜR PNEUMATISCHE OBER-UND UNTERWERKZEUGKLEMMUNG



CODE

50.650



CENTRALINA PNEUMATICA AD 1 COMANDO

PNEUMATIC EQUIPMENT WITH 1 CONTROL

CENTRAL SIMPLE NEUMÁTICA

CENTRAL PNEUMÁTICA SIMPLES

CENTRALE PNEUMATIQUE A 1 COMMANDE

STEUEREINHEIT EINFACH

CODE

50.651



CENTRALINA PNEUMATICA A 2 COMANDI

PNEUMATIC EQUIPMENT WITH 2 CONTROLS

CENTRAL NEUMÁTICA DOBLE

CENTRAL PNEUMÁTICA DUPLA

CENTRALE PNEUMATIQUE A 2 COMMANDES

STEUEREINHEIT DOPPELT

RAPID

| CODE | A | H | T/Mt | Mt |
|--------|---|--------|------|----|
| 50.800 | 7 | 100.00 | 100 | ■ |
| 50.805 | 7 | 120.00 | 100 | ■ |
| 50.810 | 7 | 150.00 | 100 | ■ |

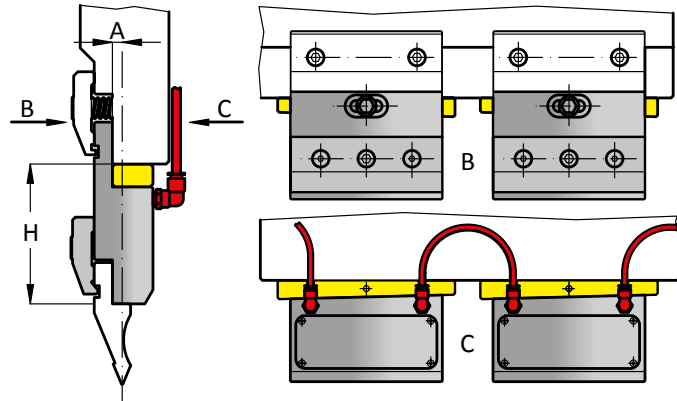

RAPID REVERSIBLE

| CODE | A | H | T/Mt | Mt |
|--------|----|--------|------|----|
| 50.870 | 7 | 100.00 | 100 | ■ |
| 50.875 | 7 | 150.00 | 100 | ■ |
| 50.890 | 20 | 120.00 | 100 | ■ |

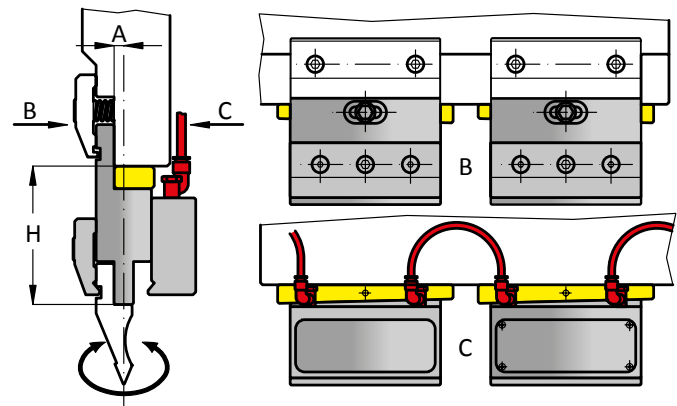

RAPID "FP"

| CODE | A | H | T/Mt | Mt |
|--------|----|--------|------|----|
| 50.820 | 7 | 100.00 | 100 | ■ |
| 50.825 | 7 | 150.00 | 100 | ■ |
| 50.830 | 20 | 120.00 | 100 | ■ |
| 50.835 | 20 | 150.00 | 100 | ■ |

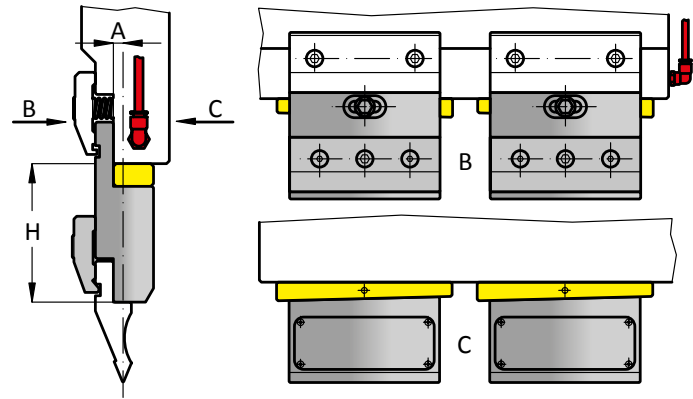

RAPID TOP-FIX

| CODE | A | H | T/Mt | Mt |
|--------|---|--------|------|----|
| 50.840 | 7 | 100.00 | 100 | ■ |
| 50.845 | 7 | 150.00 | 100 | ■ |

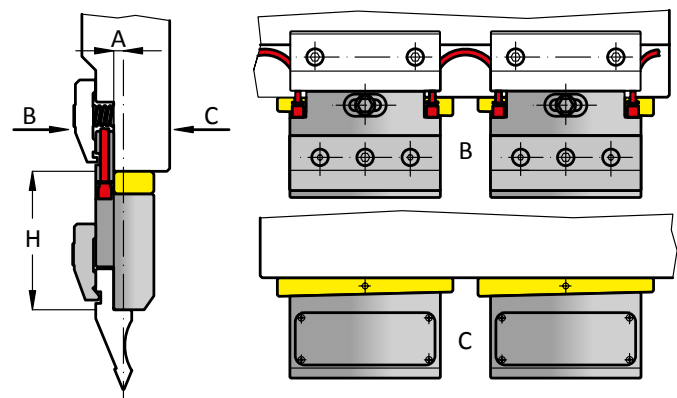

CLARK

| CODE | A | H | T/Mt | Mt |
|--------|----|--------|------|----|
| 50.600 | 7 | 100.00 | 100 | ■ |
| 50.610 | 7 | 120.00 | 100 | ■ |
| 50.615 | 7 | 150.00 | 100 | ■ |
| 50.640 | 20 | 120.00 | 100 | ■ |
| 50.646 | 20 | 150.00 | 100 | ■ |

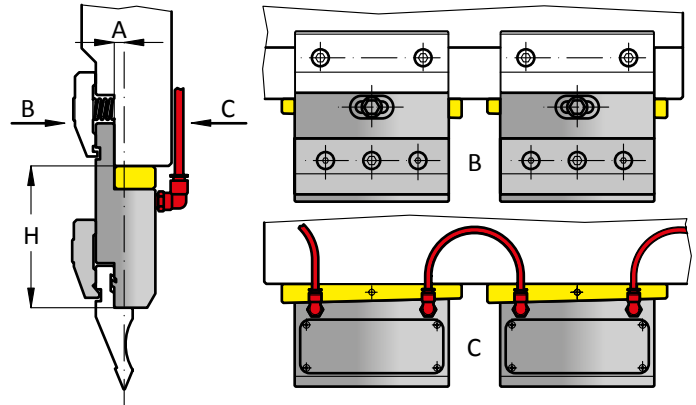

CLARK REVERSIBLE

| CODE | A | H | T/Mt | Mt |
|--------|----|--------|------|----|
| 50.730 | 7 | 100.00 | 100 | ■ |
| 50.725 | 7 | 150.00 | 100 | ■ |
| 50.731 | 20 | 120.00 | 100 | ■ |

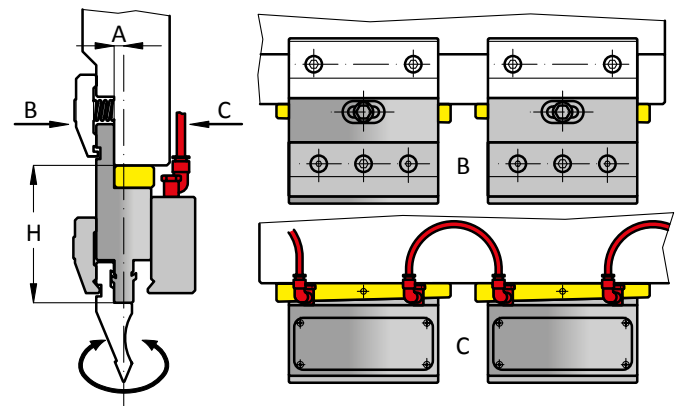

CLARK "FP"

| CODE | A | H | T/Mt | Mt |
|--------|----|--------|------|----|
| 50.635 | 7 | 100.00 | 100 | ■ |
| 50.685 | 7 | 150.00 | 100 | ■ |
| 50.645 | 20 | 120.00 | 100 | ■ |
| 50.657 | 20 | 150.00 | 100 | ■ |

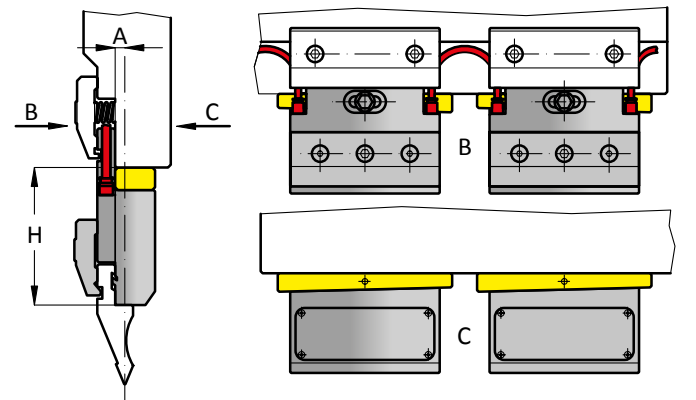

CLARK TOP-FIX

| CODE | A | H | T/Mt | Mt |
|--------|---|--------|------|----|
| 50.655 | 7 | 100.00 | 100 | ■ |
| 50.755 | 7 | 150.00 | 100 | ■ |

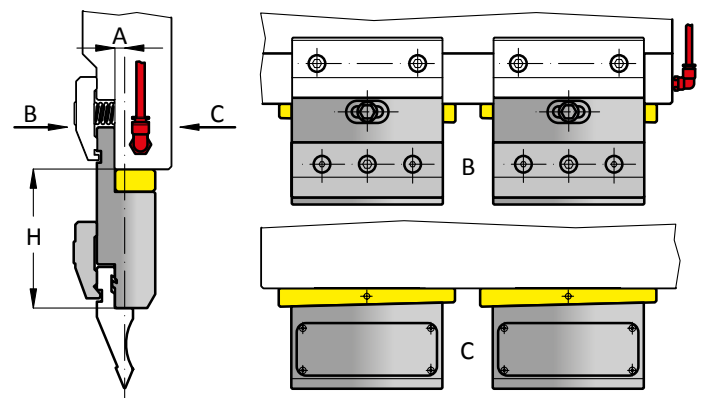

ADATTATORI PNEUMATICI INFERIORI

STAFFA PNEUMATICA INDIPENDENTE PER TAVOLE CON FORATURA PROMECAM - PNEUMATIC FREE STANDING CLAMP FOR AMADA/PROMECAM PRESS-BRAKES LOWER TABLES
 BRIDA NEUMÁTICA INDEPENDIENTE PARA MESAS TIPO AMADA/PROMECAM - BARRA PNEUMÁTICA INDEPENDIENTE PARA MESAS ROSCADAS AMADA/PROMECAM
 BRIDE PNEUMATIQUE INDEPENDANTE POUR TABLES TARAUEES AMADA/PROMECAM - PNEUMATISCHE MATRIZENKLEMMUNG FÜR MASCHINENTISCHE MIT PROMECAM GEWINDEBOHRUNG

| CODE | S | A |
|--------|-------|-----|
| 63.121 | 15x15 | 90 |
| 63.122 | 30x15 | 120 |
| 63.123 | 45x15 | 150 |
| 63.124 | 60x15 | 180 |

| CODE | Z |
|--------|---|
| 60.685 | Z |

| CODE | K |
|--------|---|
| 63.000 | K |

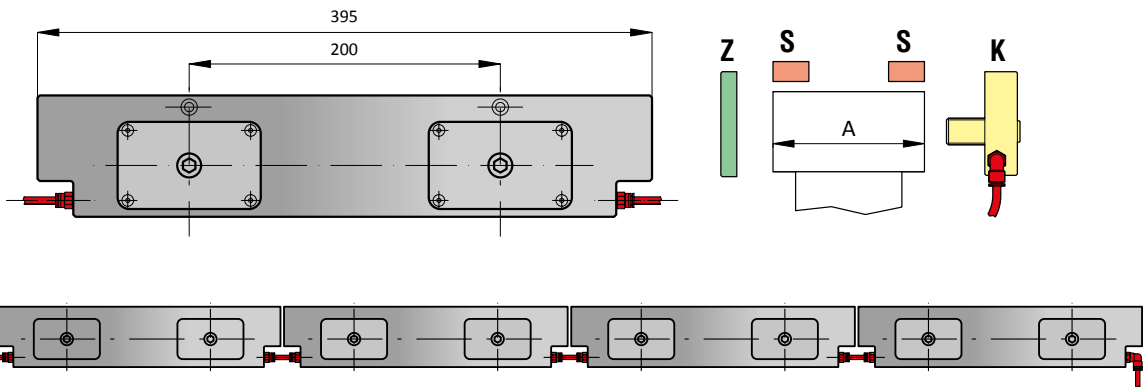
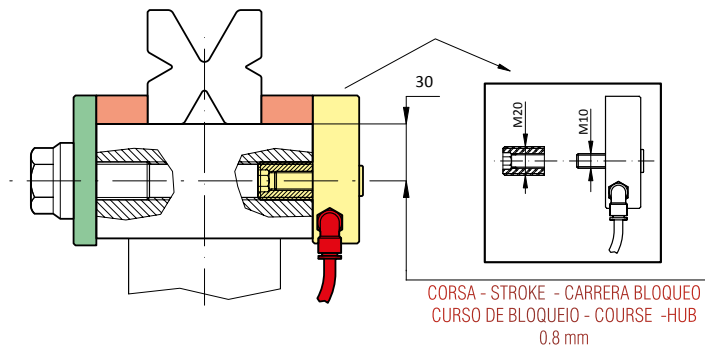

STAFFA PNEUMATICA INDIPENDENTE PER TAVOLE SCANALATE - PNEUMATIC FREE STANDING CLAMP FOR GROOVED LOWER TABLES
 BRIDA NEUMÁTICA INDEPENDIENTE PARA MESAS ACANALADAS - BARRA PNEUMÁTICA INDEPENDIENTE PARA MESAS INFERIORES COM RANHURA EM
 BRIDE PNEUMATIQUE INDEPENDANTE POUR TABLES RAINUREES - PNEUMATISCHE MATRIZENKLEMMUNG MIT FÜR MASCHINENTISCHE MIT NUT

| CODE | S | A |
|--------|-------|-----|
| 63.126 | 13x15 | 90 |
| 63.127 | 27x15 | 120 |
| 63.128 | 42x15 | 150 |
| 63.129 | 57x15 | 180 |

| CODE | Z |
|--------|---|
| 63.012 | Z |

| CODE | K |
|--------|---|
| 63.001 | K |

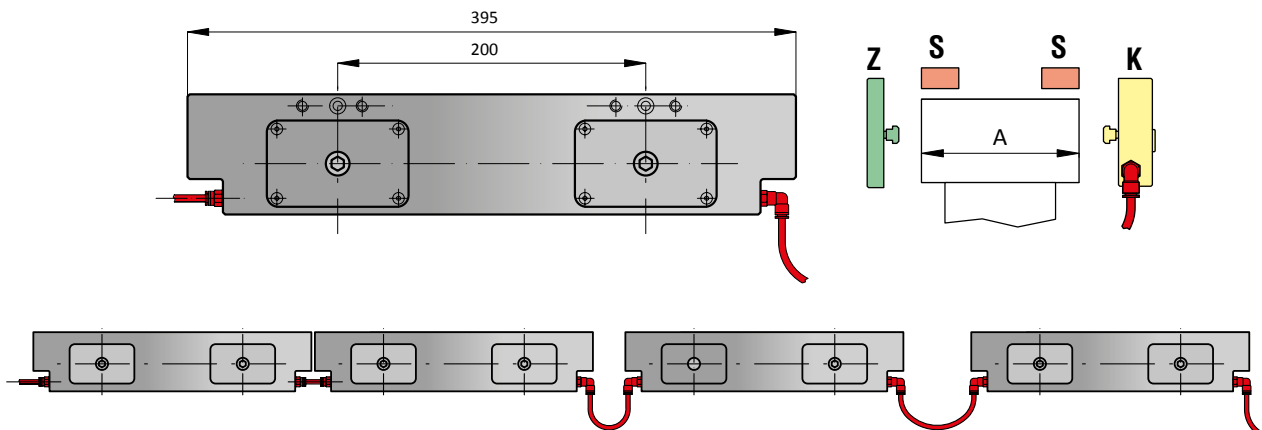
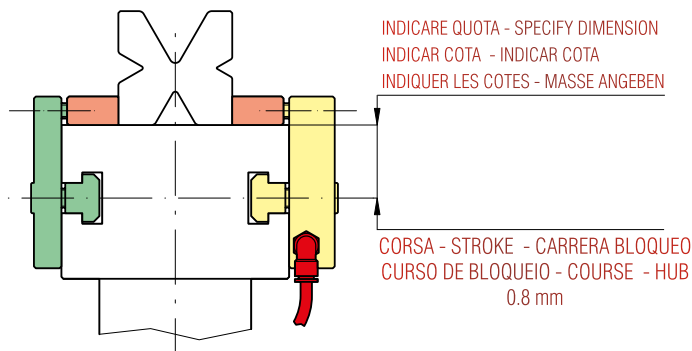

ADATTATORI PNEUMATICI INFERIORI

RIALZO MODULARE PNEUMATICO - PNEUMATIC MODULAR HOLDER - MESA PORTA MATRIZ NEUMÁTICA MODULAR
 MESA PORTA MATRIZ PNEUMÁTICA MODULAR - REHAUSSE REGLABLE PNEUMATIQUE - PNEUMATISCHER MATRIZENHALTER MODULAR

CODE

60.691

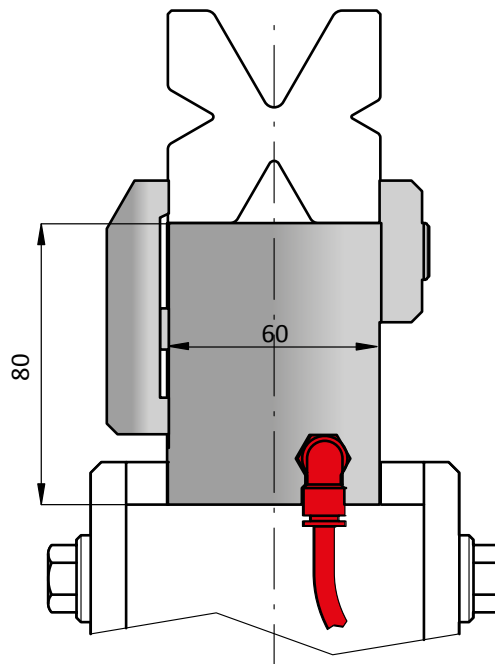

CORSA = 0.8 mm
 STROKE = 0.8 mm
 CARRERA BLOQUEO = 0.8 mm
 CURSO DE BLOQUEIO = 0.8 mm
 COURSE = 0.8 mm
 HUB = 0.8 mm

RIALZO PORTAMATRICE MODULARE A BLOCCAGGIO PNEUMATICO E SBLOCCAGGIO A MOLLA.
 MODULAR HOLDER, PNEUMATIC CLAMPING SPRING UNCLAMPING.
 SOPORTE PORTA MATRIZ MODULAR NEUMÁTICO Y DESBLOQUEO POR MUELLES.
 MESA PORTA MATRIZ MODULAR DE BLOQUEIO PNEUMÁTICO E DESBLOQUEIO POR MOLAS.
 REHAUSSE PORTE MATRICE REGLABLE PNEUMATIQUE A BLOCAGE PNEUMATIQUE ET DÉVERROUILLAGE A RESSORT.
 PNEUMATISCHER MATRIZENHALTER MODULAR, KLEMMUNG DURCH FEDER.

SCHEMA DI MONTAGGIO - ASSEMBLY SCHEME - ESQUEMA DE MONTAJE - ESQUEMA DE MONTAGEM - SCHÉMA DE MONTAGE - MONTAGESCHEMA

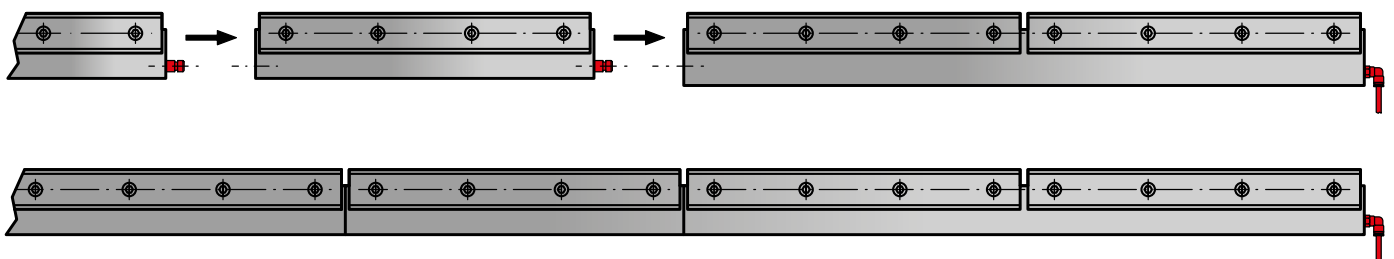

835 mm

415 mm

LENGTH | 415 835

I NOSTRI CATALOGHI

I CATALOGHI SONO DISPONIBILI SUL SITO WEB - THE CATALOGS ARE AVAILABLE ON THE WEBSITE

LOS CATÁLOGOS ESTÁN DISPONIBLES EN EL SITIO WEB - OS CATÁLOGOS ESTÃO DISPONÍVEIS NO SITE

LES CATALOGUES SONT DISPONIBLES SUR LE SITE WEB - DIE KATALOGE SIND AUF DER WEBSITE VERFÜGBAR



RED LINE

AMADA - PROMECAM STYLE



BLUE LINE

WILA - TRUMPF STYLE



ORANGE LINE

BYSTRONIC - BEYELER STYLE



RAINBOW LINE

LVD - EHT - WEINBRENNER - NEWTON STYLE



BLACK LINE

AMERICAN STYLE



CORAL LINE

NO MARKING TOOLS

I NOSTRI CATALOGHI

I CATALOGHI SONO DISPONIBILI SUL SITO WEB - THE CATALOGS ARE AVAILABLE ON THE WEBSITE

LOS CATÁLOGOS ESTÁN DISPONIBLES EN EL SITIO WEB - OS CATÁLOGOS ESTÃO DISPONÍVEIS NO SITE

LES CATALOGUES SONT DISPONIBLES SUR LE SITE WEB - DIE KATALOGE SIND AUF DER WEBSITE VERFÜGBAR



MAGENTA LINE ADAPTERS FOR ALL PRESS BRAKES



YELLOW LINE RECTILINEAR BLADES



GREEN LINE ACCESSORIES FOR ALL PRESS BRAKES



SILVER LINE WORKING - MODIFICATION - REFURBISHED TOOLING



GOLD LINE SPECIAL TOOLING FOR ALL PRESS BRAKES



QR CODE GO TO THE WEBSITE WWW.TECNOSTAMP.EU

INDEX CODE

| CODE | α | PAGE |
|--------|---|------|
| 50.200 | | 18 |
| 50.210 | | 18 |
| 50.220 | | 18 |
| 50.250 | | 18 |
| 50.310 | | 24 |
| 50.400 | | 13 |
| 50.410 | | 14 |
| 50.415 | | 14 |
| 50.430 | | 9 |
| 50.440 | | 14 |
| 50.445 | | 14 |
| 50.450 | | 10 |
| 50.470 | | 10 |
| 50.490 | | 10 |
| 50.500 | | 15 |
| 50.501 | | 15 |
| 50.502 | | 15 |
| 50.503 | | 15 |
| 50.512 | | 16 |
| 50.529 | | 22 |
| 50.551 | | 22 |
| 50.571 | | 22 |
| 50.574 | | 25 |
| 50.577 | | 25 |
| 50.600 | | 39 |
| 50.610 | | 39 |
| 50.615 | | 39 |
| 50.635 | | 39 |
| 50.640 | | 39 |
| 50.645 | | 39 |
| 50.646 | | 39 |
| 50.650 | | 37 |
| 50.651 | | 37 |
| 50.655 | | 39 |
| 50.657 | | 39 |
| 50.666 | | 16 |
| 50.667 | | 16 |
| 50.668 | | 16 |
| 50.669 | | 16 |
| 50.671 | | 11 |
| 50.673 | | 16 |
| 50.674 | | 16 |
| 50.685 | | 39 |
| 50.693 | | 24 |
| 50.697 | | 24 |
| 50.705 | | 16 |
| 50.706 | | 16 |
| 50.707 | | 16 |
| 50.708 | | 16 |
| 50.710 | | 16 |

| CODE | α | PAGE |
|--------|---|------|
| 50.712 | | 24 |
| 50.725 | | 39 |
| 50.730 | | 39 |
| 50.731 | | 39 |
| 50.755 | | 39 |
| 50.800 | | 38 |
| 50.805 | | 38 |
| 50.810 | | 38 |
| 50.820 | | 38 |
| 50.825 | | 38 |
| 50.830 | | 38 |
| 50.835 | | 38 |
| 50.840 | | 38 |
| 50.845 | | 38 |
| 50.870 | | 38 |
| 50.875 | | 38 |
| 50.890 | | 38 |
| 50.900 | | 22 |
| 50.903 | | 23 |
| 50.905 | | 23 |
| 50.910 | | 23 |
| 50.930 | | 12 |
| 50.935 | | 12 |
| 50.940 | | 9 |
| 50.945 | | 19 |
| 50.950 | | 12 |
| 50.959 | | 13 |
| 50.960 | | 12 |
| 50.972 | | 19 |
| 50.980 | | 9 |
| 50.981 | | 9 |
| 50.982 | | 13 |
| 50.983 | | 9 |
| 50.985 | | 13 |
| 50.990 | | 10 |
| 50.991 | | 10 |
| 50.992 | | 11 |
| 50.993 | | 10 |
| 50.994 | | 11 |
| 50.996 | | 11 |
| 50.997 | | 11 |
| 50.998 | | 11 |
| 60.680 | | 8 |
| 60.681 | | 8 |
| 60.682 | | 8 |
| 60.683 | | 8 |
| 60.685 | | 40 |
| 60.691 | | 41 |
| 60.710 | | 32 |
| 60.715 | | 33 |

| CODE | α | PAGE |
|---------|---|------|
| 60.720 | | 32 |
| 60.725 | | 33 |
| 60.730 | | 32 |
| 60.735 | | 33 |
| 60.910 | | 28 |
| 60.919 | | 29 |
| 60.920 | | 28 |
| 60.925 | | 29 |
| 60.930 | | 29 |
| 60.935 | | 28 |
| 60.940 | | 30 |
| 60.945 | | 30 |
| 60.950 | | 30 |
| 60.955 | | 30 |
| 60.960 | | 28 |
| 60.980 | | 29 |
| 63.000 | | 40 |
| 63.001 | | 40 |
| 63.012 | | 40 |
| 63.121 | | 40 |
| 63.122 | | 40 |
| 63.123 | | 40 |
| 63.124 | | 40 |
| 63.126 | | 40 |
| 63.127 | | 40 |
| 63.128 | | 40 |
| 63.129 | | 40 |
| 509.700 | | 9 |
| 800.000 | | 8 |
| 810.000 | | 8 |
| 820.000 | | 8 |

The image shows a digital notepad application window. At the top, there is a blue header bar with the word "NOTEPAD" in white, centered text. Below the header is a white area with a light gray, wavy, torn-paper-like border at the top edge. The main body of the notepad is white and contains horizontal gray lines for writing. Two vertical red lines are positioned on either side of the page, creating a central margin. The notepad is set against a light gray background.

NOTEPAD





SUPRA
TECHNOLOGIES



SFOP - SUPRA Technologies

lieu-dit La Carte - 37380 MONNAIE - FRANCE

Tél. +33 2 47 29 50 - Fax +33 2 47 29 80 59

www.supra-technologies.com - supra@nato-groupe.com